

SLOPE Ceiling INSULATION

- 2" Poly Iso Foam  $\times 6.5 = 13$
- 11.25" DENSE PACK FIBERGLASS  $\times 4.2 = 47$
- TOT. R = 60

EAVE OVERHANG FRAMING

- 2X6 / 2X4 @ 16" O.C. LADDER
- Hung on Ledgers & SCREWED TO Bldg

- 5/8" ADVANTECH ROOF SHEATHING
- 2 X 12 ROOF RAFTER
- 3/4" ADVANTECH SUB FLOOR

- 5/4 X 8 FACIA, 5/4 X 4 SHADOW BOARD
- 3/8 X 12" L.P. SOFFIT PANEL
- 3/8 X 24" L.P. SOFFIT PANEL
- 1 X 3 STRAPPING
- 1/2 X 8" HORIZ. LAP SIDING L.P. Smooth side

- 1 1/8" T.J.I. 2ND FLOOR DECK FRAMING Hung OFF LEDGER
- 2 X 12 FLOOR LEDGER LET INTO 2X6 WALL
- 1/2" ZIP SYSTEM ADVANTECH WALL SHEATHING
- 2 X 6 FRAMING

WALL INSULATION

- 5.5" DENSE PACK FIBERGLASS  $\times 4.2 = 23$
- 4" Poly Iso Foam  $\times 6.5 = 26$
- TOT. R = 46

LAWSON - E. BURILE VT.  
 WALL / EAVE DETAIL  
 1/23/13 REV. 2/19/13



DAVID KERR

PO BOX 572 • BETHLEHEM, NH 03574 • 603/616-7884

ZX6 OVERHANG Ladder  
@ 16" O.C.

1/2" ZIP wall  
TO TOP OF  
GABLE FRAMING

4" Poly Iso Foam  
EXTERIOR RUN ROOF  
DECK BTWN OUTLOOKERS  
(EXTERIOR)

ZX6 GABLE END  
FRAMING  
DENSE PACK FBGLS

2" Poly Iso Foam  
INTERIOR

ZX12 ROOF RAFTER  
BAYS FILLED WITH  
DENSE PACK FIBERGLASS

24" O.C.

ZX6 wall  
FRAMING  
DENSE PACK  
FIBERGLASS

4" Poly Iso Foam

Lawson  
Elev. view  
Roof Frame /  
Insulation Detail

3/19/13  
D. Kerr

GABLE END

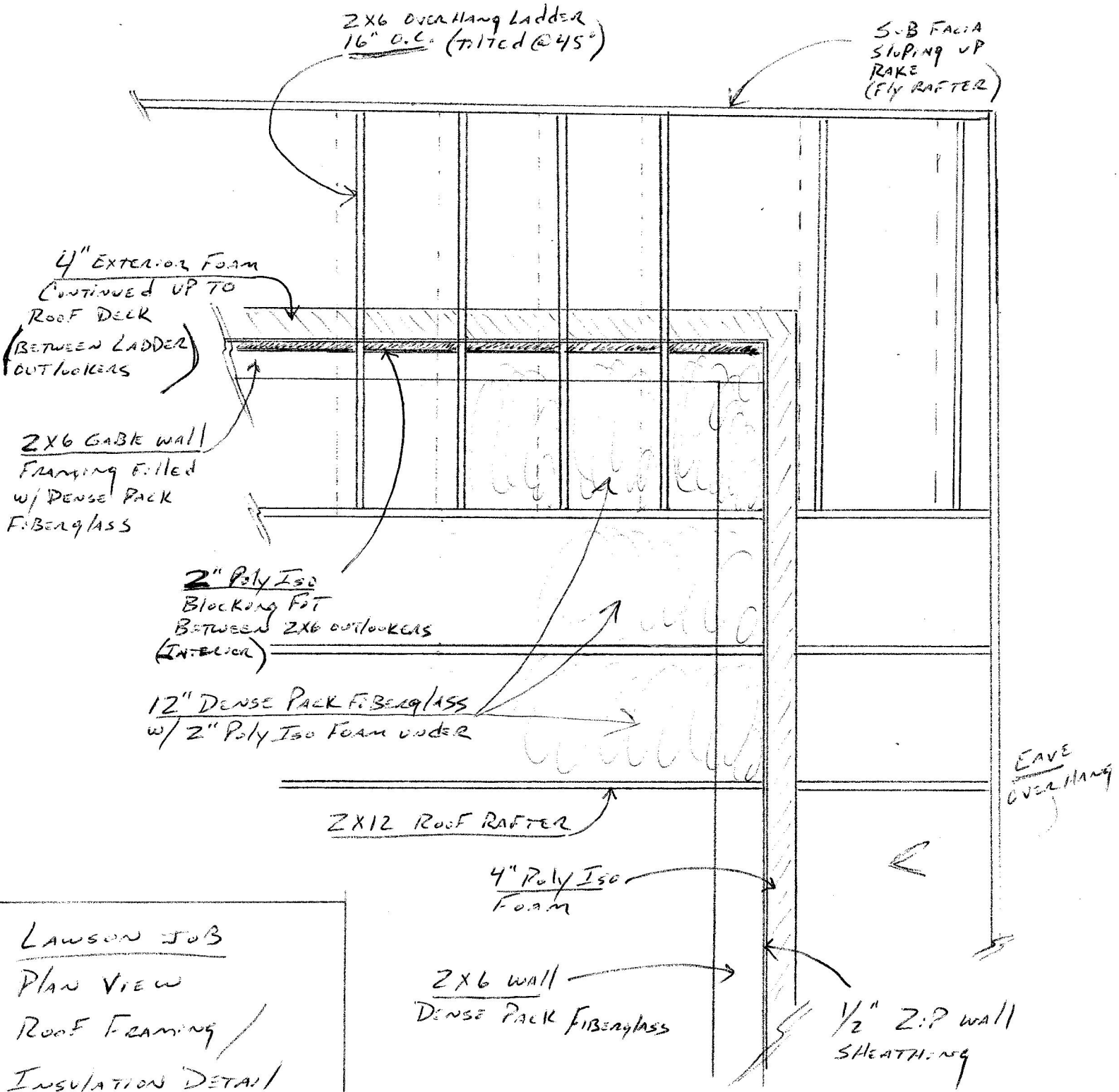

LAWSON JOB

PLAN VIEW

ROOF FRAMING /

INSULATION DETAIL

3/14/13

D. KERR