

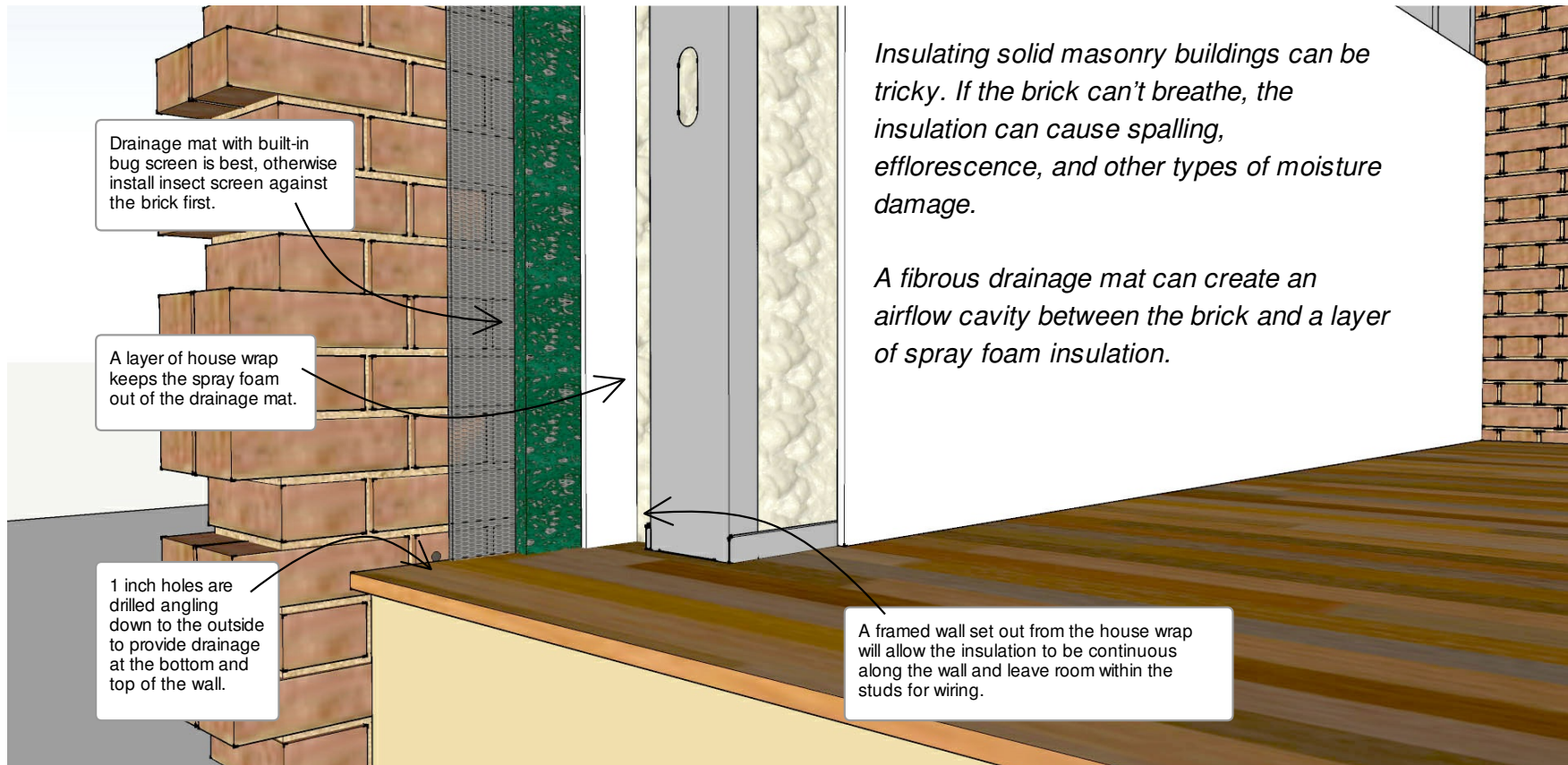

How to Insulate Solid Masonry Walls

(without causing moisture problems)



Drainage mat with built-in bug screen is best, otherwise install insect screen against the brick first.

A layer of house wrap keeps the spray foam out of the drainage mat.

1 inch holes are drilled angling down to the outside to provide drainage at the bottom and top of the wall.

Insulating solid masonry buildings can be tricky. If the brick can't breathe, the insulation can cause spalling, efflorescence, and other types of moisture damage.

A fibrous drainage mat can create an airflow cavity between the brick and a layer of spray foam insulation.

A framed wall set out from the house wrap will allow the insulation to be continuous along the wall and leave room within the studs for wiring.

Watch the animated drawing on your phone.

<http://goo.gl/dCLicr>



Source: Dr Kim Pressnail, PH.D., University of Toronto Department of Civil Engineering.
Illustration: Daniel Morrison

www.ProTradeCraft.com

Copyright 2015, SGC HORIZON, all rights reserved.