

A LOOK INSIDE

Taking cues from Sarah Susanka's *Not So Big House* concept, which shows that good design can help a modest space work better than a big one, the floor plan incorporates design principles that make the house more attentive to the homeowners' needs and tastes. This single-level home has wide doorways and no interior thresholds, a walk-in shower, lots of built-in storage, and cabinets the author built.

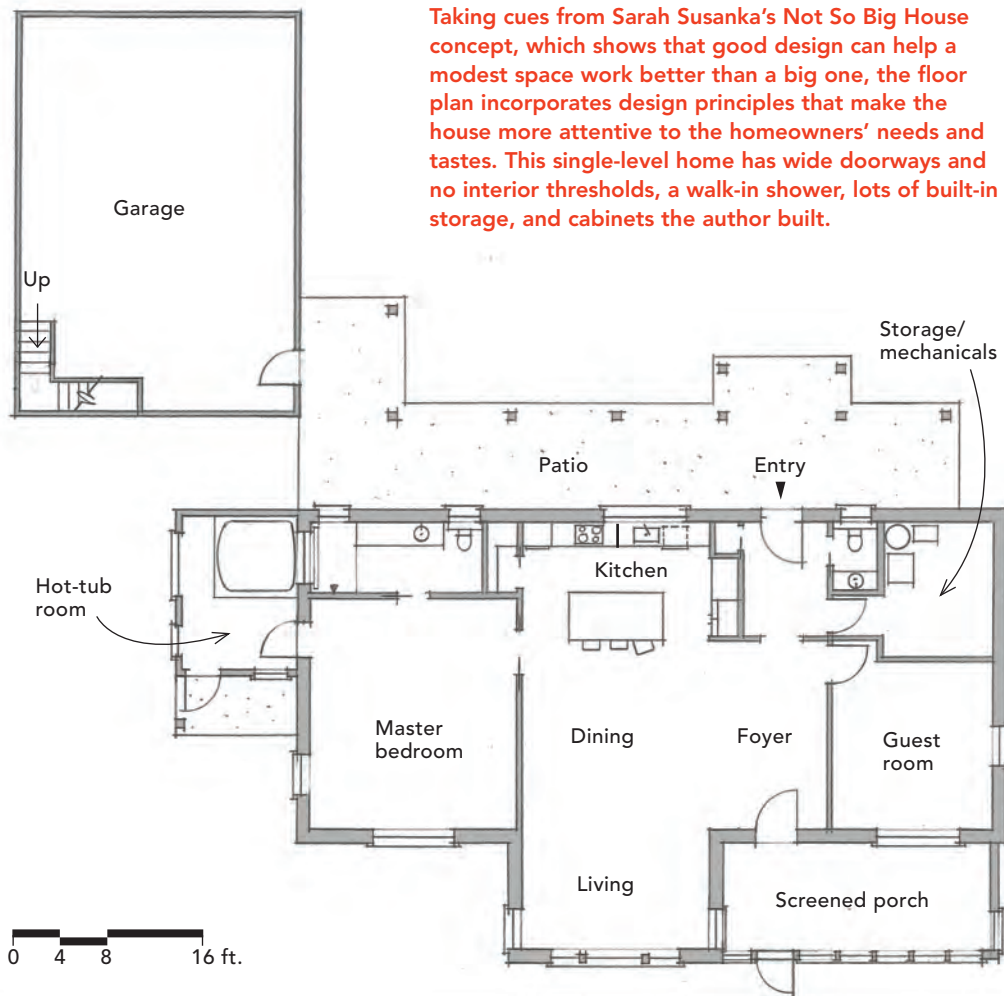

Passive solar. The south-facing, triple-glazed *Intus* windows are Passive House certified. The low-maintenance concrete floors store heat from the sun.

