

2x10 FRAMING INSULATION ASSEMBLY

I AM ASSUMING THE SITE BUILT
BAFFLES ARE REQUIRED TO BE
CONTINUOUS FROM EAVE TO
EAVE?

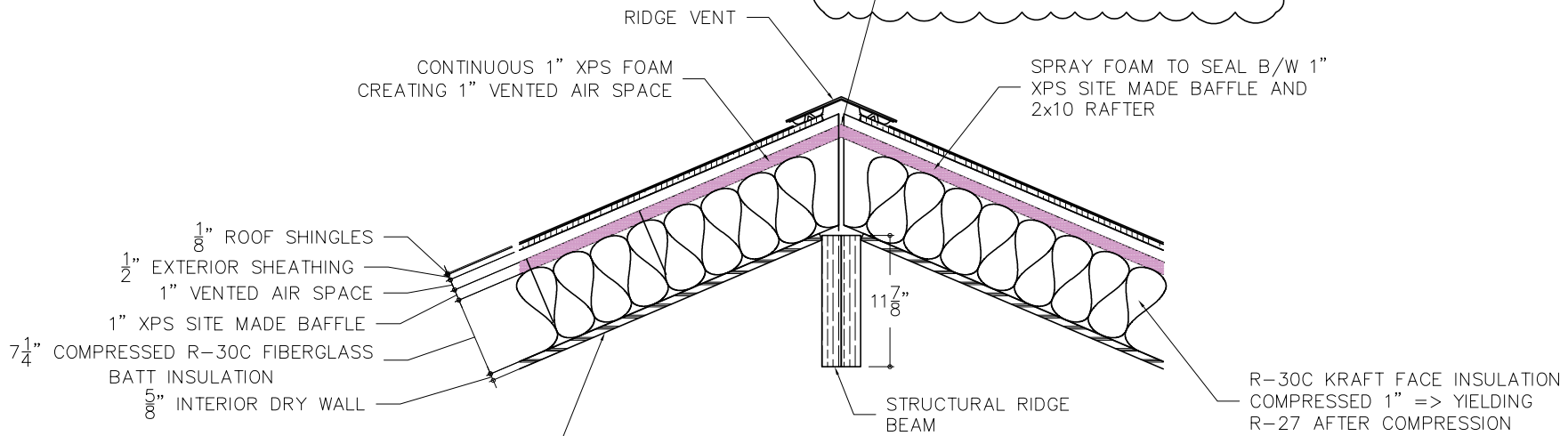

IS REGULAR LATEX PAINT OVER
GYPSUM BOARD OK?

IS THE KRAFT FACED CONSIDERED A TRUE
"SMART" VAPOR BARRIER? SHOULD I GO
UNFACED?

THIS ASSEMBLY IS SANDWICHING THE
FIBERGLASS INSULATION BETWEEN TWO VAPOR
BARRIERS... IS THIS OK? WILL KRAFT PAPER
ALLOW DRYING OF ANY POSSIBLE VAPOR ENTRY?
THE DRY WALL WILL BE INSTALLED AS AIR TIGHT
AS POSSIBLE W/ NO CAN LIGHTS, ETC.

NOTE: THE SITE MADE XPS INSULATION Baffles
DO NOT MEET THE 20% INSULATION
REQUIREMENT FOR AN INWARD DRYING ROOF.

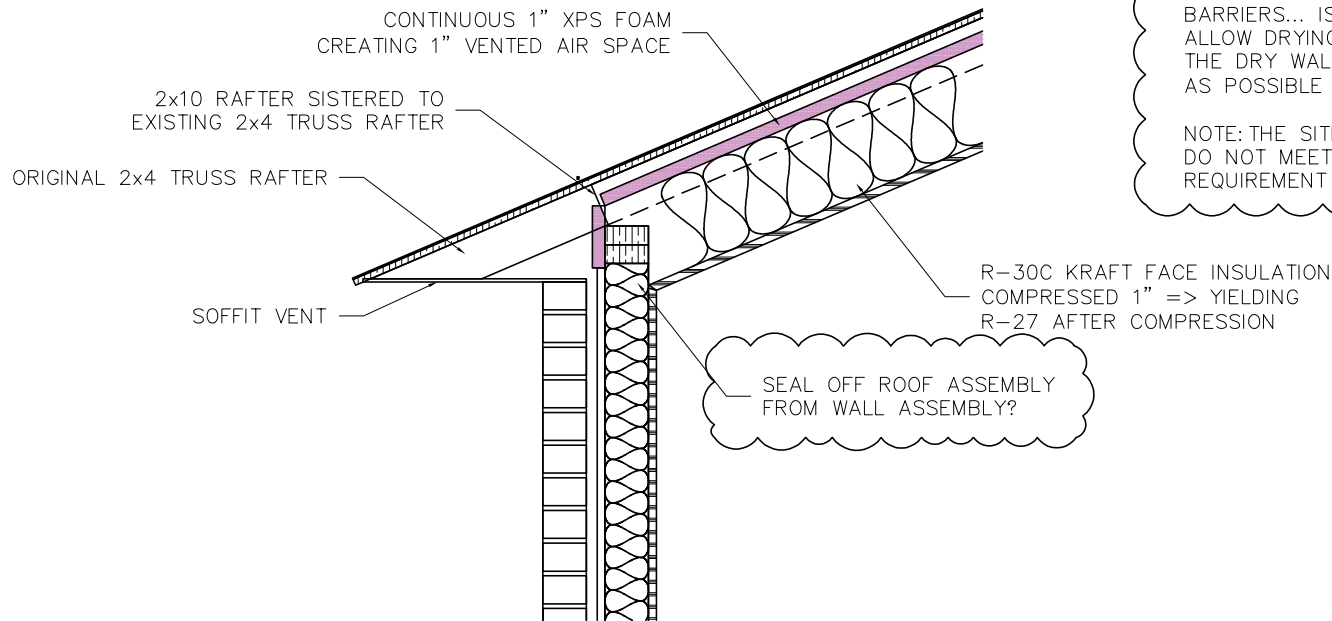

SEAL OFF ROOF ASSEMBLY
FROM WALL ASSEMBLY?