

11 Lakeside Drive, New Rochelle, NY 10801

Project Information

For: Ryan
 11 Lakeside Drive, New Rochelle, NY 10801

Design Information

	Htg	Clg		Infiltration
Outside db (°F)	9	87	Method	Blower door
Inside db (°F)	71	70	Shielding / stories	3 (partial) / 3
Design TD (°F)	62	17	Pressure / AVF	50 Pa / 3025 cfm
Daily range	-	M		
Inside humidity (%)	43	50		
Moisture difference (gr/lb)	51	42		

HEATING EQUIPMENT

Make	
Trade	
Model	
AHRI ref	
Efficiency	80 AFUE
Heating input	0 Btuh
Heating output	0 Btuh
Low output baseboard	500 Btuh/ft
Total low baseboard	126 ft
High output baseboard	700 Btuh/ft
Total high baseboard	90 ft
Space thermostat	

COOLING EQUIPMENT

Make	
Trade	
Cond	
Coil	
AHRI ref	
Efficiency	0 SEER
Sensible cooling	0 Btuh
Latent cooling	0 Btuh
Total cooling	0 Btuh
Actual air flow	1588 cfm
Air flow factor	0.061 cfm/Btuh
Static pressure	0 in H2O
Load sensible heat ratio	0.83

ROOM NAME	Area (ft²)	Htg load (Btuh)	Clg load (Btuh)	Baseboard (ft)		Clg AVF (cfm)
				Low	High	
Downstairs	1118	35543	17378	71	51	1068
Upstairs	835	20363	9151	41	29	563
Basement	1104	6938	1685	14	10	104
Entire House	3057	62844	25832	126	90	1588
Other equip loads		0	0			
Equip. @ 0.92 RSM			23636			
Latent cooling			5294			
TOTALS	3057	62844	28930	126	90	1588

Calculations approved by ACCA to meet all requirements of Manual J 8th Ed.

11 Lakeside Drive, New Rochelle, NY 10801

Project Information

For: Ryan
11 Lakeside Drive, New Rochelle, NY 10801

Design Information

	Htg	Clg	Method	Infiltration
Outside db (°F)	9	87		Blower door
Inside db (°F)	55	77	Shielding / stories	3 (partial) / 3
Design TD (°F)	46	10	Pressure / AVF	50 Pa / 3025 cfm
Daily range	-	M		
Inside humidity (%)	30	50		
Moisture difference (gr/lb)	12	27		

HEATING EQUIPMENT

Make	n/a
Trade	n/a
Model	n/a
AHRI ref	n/a
Efficiency	n/a
Heating input	
Heating output	0 Btuh
Low output baseboard	500 Btuh/ft
Total low baseboard	0 ft
High output baseboard	700 Btuh/ft
Total high baseboard	0 ft
Space thermostat	n/a

COOLING EQUIPMENT

Make	n/a
Trade	n/a
Cond	n/a
Coil	n/a
AHRI ref	n/a
Efficiency	n/a
Sensible cooling	0 Btuh
Latent cooling	0 Btuh
Total cooling	0 Btuh
Actual air flow	0 cfm
Air flow factor	0 cfm/Btuh
Static pressure	0 in H2O
Load sensible heat ratio	0

ROOM NAME	Area (ft²)	Htg load (Btuh)	Clg load (Btuh)	Baseboard (ft)		Clg AVF (cfm)
				Low	High	
PlayBoilerRoom	281	1449	946	3	2	58
Laundry Room	170	908	366	2	1	23
Future Bedroom	273	951	373	2	1	23
Garage	380	3631	0	7	5	0
Basement	1104	6938	1685	14	10	104
Other equip loads		0	0			
Equip. @ 0.92 RSM			1542			
Latent cooling			0			
TOTALS	1104	6938	1542	14	10	104

Calculations approved by ACCA to meet all requirements of Manual J 8th Ed.

Project Information

For: Ryan
11 Lakeside Drive, New Rochelle, NY 10801

Design Information

	Htg	Clg		Infiltration
Outside db (°F)	9	87	Method	Blower door
Inside db (°F)	72	70	Shielding / stories	3 (partial) / 3
Design TD (°F)	63	17	Pressure / AVF	50 Pa / 3025 cfm
Daily range	-	M		
Inside humidity (%)	50	50		
Moisture difference (gr/lb)	52	42		

HEATING EQUIPMENT

Make	n/a
Trade	n/a
Model	n/a
AHRI ref	n/a
Efficiency	n/a
Heating input	
Heating output	0 Btuh
Low output baseboard	500 Btuh/ft
Total low baseboard	0 ft
High output baseboard	700 Btuh/ft
Total high baseboard	0 ft
Space thermostat	n/a

COOLING EQUIPMENT

Make	n/a
Trade	n/a
Cond	n/a
Coil	n/a
AHRI ref	n/a
Efficiency	n/a
Sensible cooling	0 Btuh
Latent cooling	0 Btuh
Total cooling	0 Btuh
Actual air flow	0 cfm
Air flow factor	0 cfm/Btuh
Static pressure	0 in H2O
Load sensible heat ratio	0

ROOM NAME	Area (ft²)	Htg load (Btuh)	Clg load (Btuh)	Baseboard (ft)		Clg AVF (cfm)
				Low	High	
Office	80	2542	619	5	4	38
Turtle Room	224	4938	2580	10	7	159
Guest Bathroom	30	863	352	2	1	22
Family Room	154	5189	2689	10	7	165
Fourier	20	1065	326	2	2	20
Closet	15	1360	298	3	2	18
Living Room	391	17811	10105	36	25	621
Kitchen	204	1776	409	4	3	25

Calculations approved by ACCA to meet all requirements of Manual J 8th Ed.

Downstairs	1118	35543	17378	71	51	1068
Other equip loads		0	0			
Equip. @ 0.92 RSM			15901			
Latent cooling			3027			
TOTALS	1118	35543	18928	71	51	1068

Calculations approved by ACCA to meet all requirements of Manual J 8th Ed.



11 Lakeside Drive, New Rochelle, NY 10801

Project Information

For: Ryan
11 Lakeside Drive, New Rochelle, NY 10801

Design Information

	Htg	Clg		Infiltration
Outside db (°F)	9	87	Method	Blower door
Inside db (°F)	70	70	Shielding / stories	3 (partial) / 3
Design TD (°F)	61	17	Pressure / AVF	50 Pa / 3025 cfm
Daily range	-	M		
Inside humidity (%)	50	50		
Moisture difference (gr/lb)	48	42		

HEATING EQUIPMENT

Make	n/a
Trade	n/a
Model	n/a
AHRI ref	n/a
Efficiency	n/a
Heating input	
Heating output	0 Btuh
Low output baseboard	500 Btuh/ft
Total low baseboard	0 ft
High output baseboard	700 Btuh/ft
Total high baseboard	0 ft
Space thermostat	n/a

COOLING EQUIPMENT

Make	n/a
Trade	n/a
Cond	n/a
Coil	n/a
AHRI ref	n/a
Efficiency	n/a
Sensible cooling	0 Btuh
Latent cooling	0 Btuh
Total cooling	0 Btuh
Actual air flow	0 cfm
Air flow factor	0 cfm/Btuh
Static pressure	0 in H2O
Load sensible heat ratio	0

ROOM NAME	Area (ft²)	Htg load (Btuh)	Clg load (Btuh)	Baseboard (ft)		Clg AVF (cfm)
				Low	High	
Guest Bedroom	154	4016	1483	8	6	91
Master Bathroom	60	907	623	2	1	38
Perls Bedroom	140	3550	1431	7	5	88
Guest Closet	16	547	147	1	1	9
Hall Closet	8	14	16	0	0	1
Master Clst	6	12	10	0	0	1
Master Fourier	48	901	472	2	1	29
Kids Bath	62	2065	621	4	3	38
Master Bedroom	240	7550	3921	15	11	241
Hallway	101	802	428	2	1	26

Calculations approved by ACCA to meet all requirements of Manual J 8th Ed.

Upstairs	835	20363	9151	41	29	563
Other equip loads		0	0			
Equip. @ 0.92 RSM			8373			
Latent cooling			2267			
TOTALS	835	20363	10640	41	29	563

Calculations approved by ACCA to meet all requirements of Manual J 8th Ed.



11 Lakeside Drive, New Rochelle, NY 10801

Project Information

For: Ryan
11 Lakeside Drive, New Rochelle, NY 10801

Design Conditions

Location:		Indoor:		Heating	Cooling
Westchester Co, NY, US		Indoor temperature (°F)		71	70
Elevation: 397 ft		Design TD (°F)		62	17
Latitude: 41°N		Relative humidity (%)		43	50
		Moisture difference (gr/lb)		50.8	41.8
Outdoor:	Heating	Cooling	Infiltration:		
Drybulb (°F)	9	87	Method	Blower door	
Daily range (°F)	-	17 (M)	Shielding / stories	3 (partial) / 3	
Wet bulb (°F)	-	72	Pressure / AVF	50 Pa / 3025 cfm	
Wind speed (mph)	15.0	7.5			

Heating

Component	Btuh/ft²	Btuh	% of load
Walls	3.8	13029	20.7
Glazing	24.3	8129	12.9
Doors	27.3	4389	7.0
Ceilings	8.5	11221	17.9
Floors	0.9	1017	1.6
Infiltration	10.9	25059	39.9
Ducts		0	0
Piping		0	0
Humidification		0	0
Ventilation		0	0
Adjustments		0	0
Total		62844	100.0

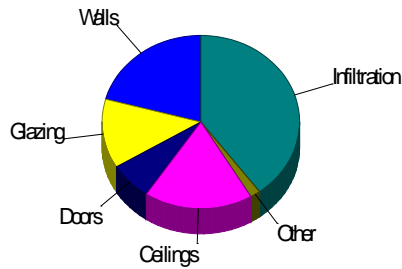

Cooling

Component	Btuh/ft²	Btuh	% of load
Walls	1.3	4473	17.3
Glazing	28.5	9537	36.9
Doors	4.9	797	3.1
Ceilings	5.8	7635	29.6
Floors	0.0	7	0.0
Infiltration	1.5	3383	13.1
Ducts		0	0
Ventilation		0	0
Internal gains		0	0
Blower		0	0
Adjustments		0	0
Total		25832	100.0

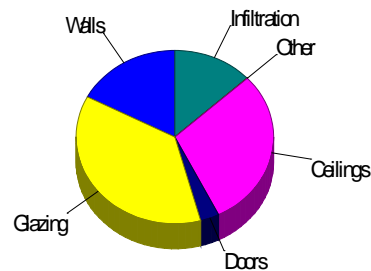

Latent Cooling Load = 5294 Btuh
Overall U-value = 0.106 Btuh/ft²-°F

Data entries checked.

11 Lakeside Drive, New Rochelle, NY 10801

Project Information

For: Ryan
11 Lakeside Drive, New Rochelle, NY 10801

Design Conditions

Location:		Indoor:		Heating	Cooling
Westchester Co, NY, US		Indoor temperature (°F)		55	77
Elevation: 397 ft		Design TD (°F)		46	10
Latitude: 41°N		Relative humidity (%)		30	50
		Moisture difference (gr/lb)		12.4	26.8
Outdoor:	Heating	Cooling	Infiltration:		
Drybulb (°F)	9	87	Method	Blower door	
Daily range (°F)	-	17 (M)	Shielding / stories	3 (partial) / 3	
Wet bulb (°F)	-	72	Pressure / AVF	50 Pa / 3025 cfm	
Wind speed (mph)	15.0	7.5			

Heating

Component	Btuh/ft²	Btuh	% of load
Walls	1.3	1822	26.3
Glazing	22.0	992	14.3
Doors	26.5	3159	45.5
Ceilings	0	0	0
Floors	0.9	965	13.9
Infiltration	0	0	0
Ducts		0	0
Piping		0	0
Humidification		0	0
Ventilation		0	0
Adjustments		0	0
Total		6938	100.0

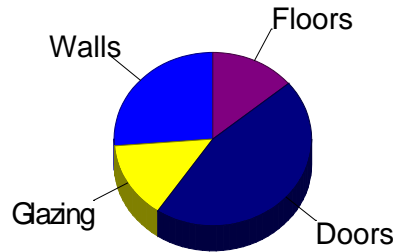

Cooling

Component	Btuh/ft²	Btuh	% of load
Walls	0.2	227	13.5
Glazing	27.5	1237	73.4
Doors	1.9	222	13.1
Ceilings	0	0	0
Floors	0	0	0
Infiltration	0	0	0
Ducts		0	0
Ventilation		0	0
Internal gains		0	0
Blower		0	0
Adjustments		0	0
Total		1685	100.0

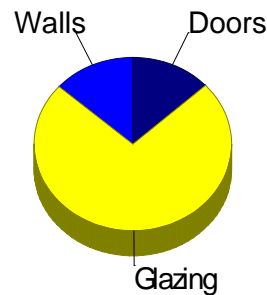

Latent Cooling Load = 0 Btuh
Overall U-value = 0.068 Btuh/ft²-°F

WARNING: window to floor area ratio = 4.1% - less than 5%.

11 Lakeside Drive, New Rochelle, NY 10801

Project Information

For: Ryan
11 Lakeside Drive, New Rochelle, NY 10801

Design Conditions

Location:

Westchester Co, NY, US
Elevation: 397 ft
Latitude: 41°N

Outdoor:

Drybulb (°F)
Daily range (°F)
Wet bulb (°F)
Wind speed (mph)

Heating

9
-
-
15.0

Cooling

87
17 (M)
72
7.5

Indoor:

Indoor temperature (°F)
Design TD (°F)
Relative humidity (%)
Moisture difference (gr/lb)

Heating

72
63
50
52.3

Cooling

70
17
50
41.8

Infiltration:

Method
Shielding / stories
Pressure / AVF

Blower door
3 (partial) / 3
50 Pa / 3025 cfm

Heating

Component	Btuh/ft²	Btuh	% of load
Walls	5.6	6223	17.5
Glazing	25.9	5117	14.4
Doors	29.3	1230	3.5
Ceilings	17.7	8423	23.7
Floors	1.8	25	0.1
Infiltration	11.0	14526	40.9
Ducts		0	0
Piping		0	0
Humidification		0	0
Ventilation		0	0
Adjustments		0	0
Total		35543	100.0

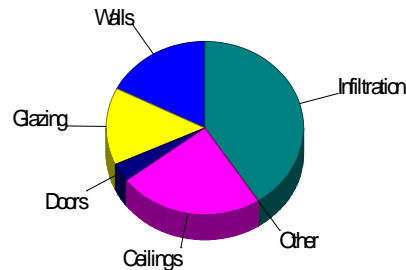

Cooling

Component	Btuh/ft²	Btuh	% of load
Walls	2.1	2285	13.2
Glazing	35.9	7098	40.8
Doors	13.7	575	3.3
Ceilings	11.5	5478	31.5
Floors	0.5	7	0.0
Infiltration	1.5	1934	11.1
Ducts		0	0
Ventilation		0	0
Internal gains		0	0
Blower		0	0
Adjustments		0	0
Total		17378	100.0

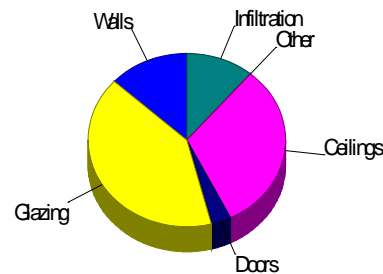

Latent Cooling Load = 3027 Btuh
Overall U-value = 0.181 Btuh/ft²-°F

Data entries checked.

11 Lakeside Drive, New Rochelle, NY 10801

Project Information

For: Ryan
11 Lakeside Drive, New Rochelle, NY 10801

Design Conditions

Location:

Westchester Co, NY, US
Elevation: 397 ft
Latitude: 41°N

Outdoor:

Drybulb (°F)
Daily range (°F)
Wet bulb (°F)
Wind speed (mph)

Heating

9
-
-
15.0

Cooling

87
17 (M)
72
7.5

Indoor:

Indoor temperature (°F)
Design TD (°F)
Relative humidity (%)
Moisture difference (gr/lb)

Heating

70
61
50
48.5

Cooling

70
17
50
41.8

Infiltration:

Method
Shielding / stories
Pressure / AVF

Blower door
3 (partial) / 3
50 Pa / 3025 cfm

Heating

Component	Btuh/ft²	Btuh	% of load
Walls	5.5	4984	24.5
Glazing	22.0	2020	9.9
Doors	0	0	0
Ceilings	3.3	2798	13.7
Floors	1.3	27	0.1
Infiltration	10.7	10533	51.7
Ducts		0	0
Piping		0	0
Humidification		0	0
Ventilation		0	0
Adjustments		0	0
Total		20363	100.0

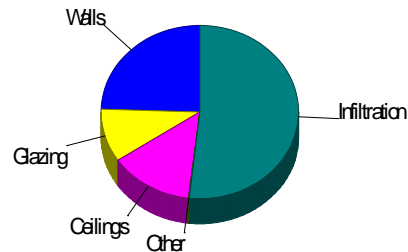

Cooling

Component	Btuh/ft²	Btuh	% of load
Walls	2.2	1961	21.4
Glazing	39.0	3585	39.2
Doors	0	0	0
Ceilings	2.5	2157	23.6
Floors	0	0	0
Infiltration	1.5	1449	15.8
Ducts		0	0
Ventilation		0	0
Internal gains		0	0
Blower		0	0
Adjustments		0	0
Total		9151	100.0

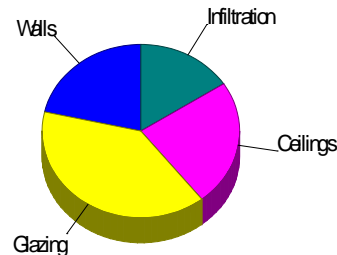

Latent Cooling Load = 2267 Btuh
Overall U-value = 0.086 Btuh/ft²-°F

Data entries checked.