

NOTE:  
OFFSET EXTERIOR STUDS 1-1/2" TO  
THE OUTSIDE FACE OF FOUNDATION  
WHERE EXT. FND. INSUL. IS APPLIED,  
EXCEPT WHERE NOTED.

SQUARE FOOTAGE	
MAIN -	1936#
LOWER -	1479#
SCREEN PORCH -	266#
GOLF ROOM -	348#
TOTAL (FNU) -	4039#
MECH -	157#
GARAGE -	934#

MARVIN INTEGRITY 4 MARVIN  
ULTIMATE WINDOW CODES (UNLESS  
NOTED OTHERWISE)

NOTE - ALL WINDOW & DOOR HEAD  
HGTs. TO BE SET AT 8'-0" AT LWR  
LEVEL UNLESS NOTED OTHERWISE

1  
4 LOWER LEVEL FLOOR PLAN  
SCALE: 1/4"=1'-0"

- PLAN KEYNOTES**
- EXTERIOR WALLS WITH 2x6 STUDS SPACED AT 16" O.C. WITH 1/2" SHEATHING PANELS ATTACHED TO FRAMING WITH 8D NAILS SPACED AT 6" O.C. ALONG ALL PANEL EDGES AND 12" O.C. AT THE INTERMEDIATE STUDS.
  - INTERIOR WALL: 2x4 OR 2x6 STUDS SPACED AT 16" O.C. WITH 1/2" MINIMUM GYPSUM BOARD SHEATHING PANELS AT BOTH SIDES OF THE WALL ATTACHED TO FRAMING WITH 5D COOLER OR WALLBOARD NAILS OR 5/16 WALLBOARD SCREWS AT 1" O.C. ALONG ALL PANEL EDGES.
  - EXTERIOR WALLS WITH 2x6 STUDS SPACED AT 16" O.C. WITH 1/2" SHEATHING PANELS ATTACHED TO FRAMING WITH 8D NAILS SPACED AT 4" O.C. ALONG ALL PANEL EDGES AND 12" O.C. AT THE INTERMEDIATE STUDS.
  - FLOOR TRUSSES OR JOISTS SPACED AS SHOWN ON THE PLANS WITH 3/4" PLYWOOD SHEATHING ATTACHED WITH 8D NAILS SPACED AT 6" O.C. ALONG ALL PANEL EDGES AND 12" O.C. AT THE INTERMEDIATE FRAMING MEMBERS.
  - ROOF TRUSSES, JOISTS OR RAFTERS SPACED AT 24" O.C. (MAXIMUM) WITH 1/2" OSB OR PLYWOOD SHEATHING ATTACHED WITH 8D NAILS SPACED AT 6" O.C. ALONG ALL PANEL EDGES AND 12" O.C. AT THE INTERMEDIATE FRAMING MEMBERS.
  - INSTALL PORTAL FRAME PER MINNESOTA RESIDENTIAL CODE FIGURE R602.10.6.2. TIE HEADER TO JAMB STUDS WITH SIMPSON L57A18 STEEL STRAP TIE AT THE INSIDE FACE OF THE FRAMING.
  - ATTACH PORTAL FRAME STUDS TO CONCRETE FOUNDATION WALL WITH SIMPSON 5THD4 HOLD-DOWN ANCHOR CAST INTO THE CONCRETE FOUNDATION WALL AND NAILED TO THE OUTSIDE OF THE WALL STUDS.

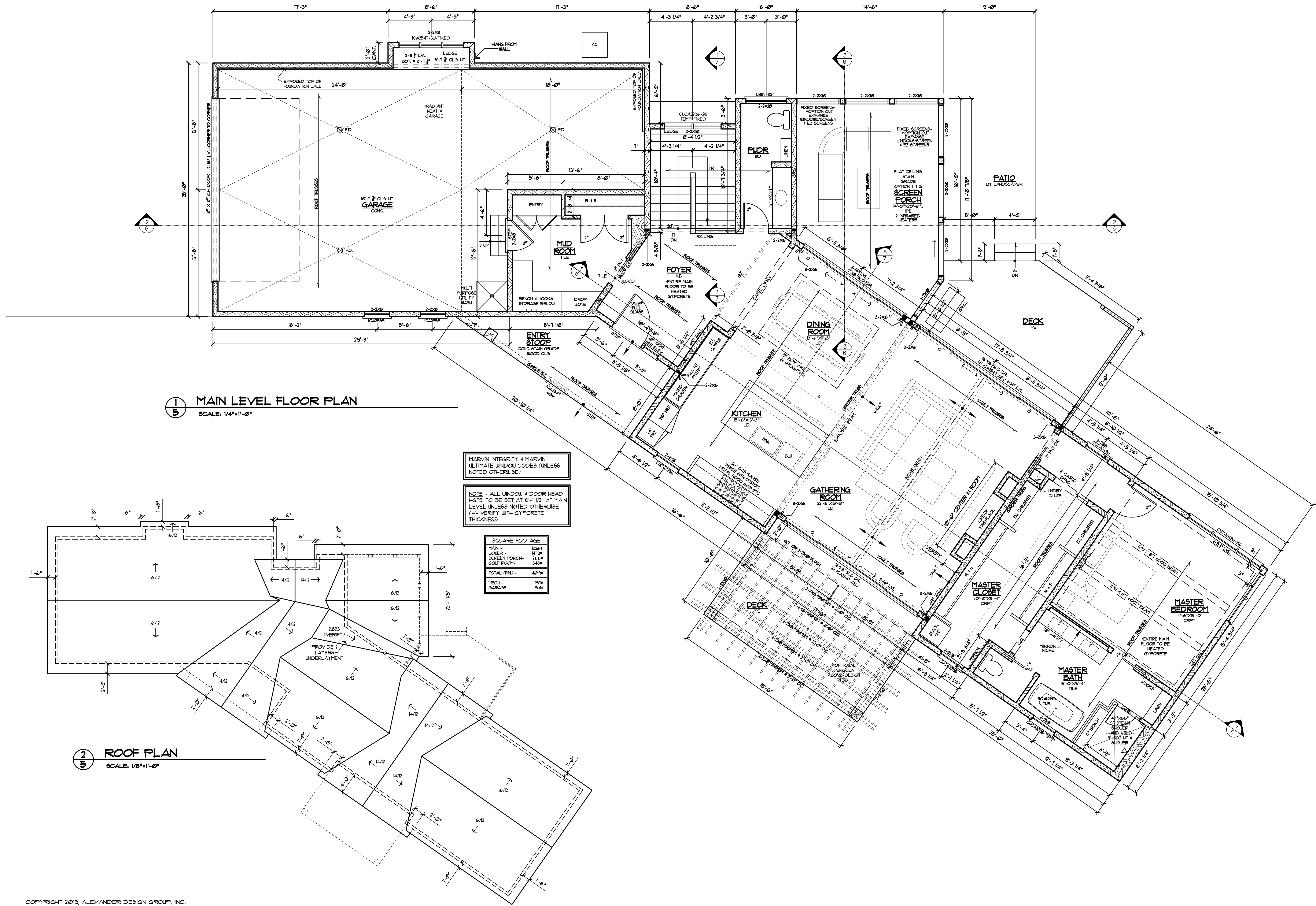

**1**  
**5** MAIN LEVEL FLOOR PLAN  
SCALE: 1/4"=1'-0"

**2**  
**5** ROOF PLAN  
SCALE: 1/8"=1'-0"

MARVIN INTEGRITY 4 MARVIN ULTIMATE WINDOW CODES (UNLESS NOTED OTHERWISE)

NOTE - ALL WINDOW & DOOR HEAD HGT'S. TO BE SET AT 8'-1 1/2" AT MAIN LEVEL UNLESS NOTED OTHERWISE (+/- VERIFY WITH GYPCRETE THICKNESS)

SQUARE FOOTAGE	
MAIN -	1926#
LOUER -	1479#
SCREEN PORCH -	266#
GOLF ROOM -	348#
<b>TOTAL (FNU) -</b>	<b>4019#</b>
HEGH -	19#
GARAGE -	944#



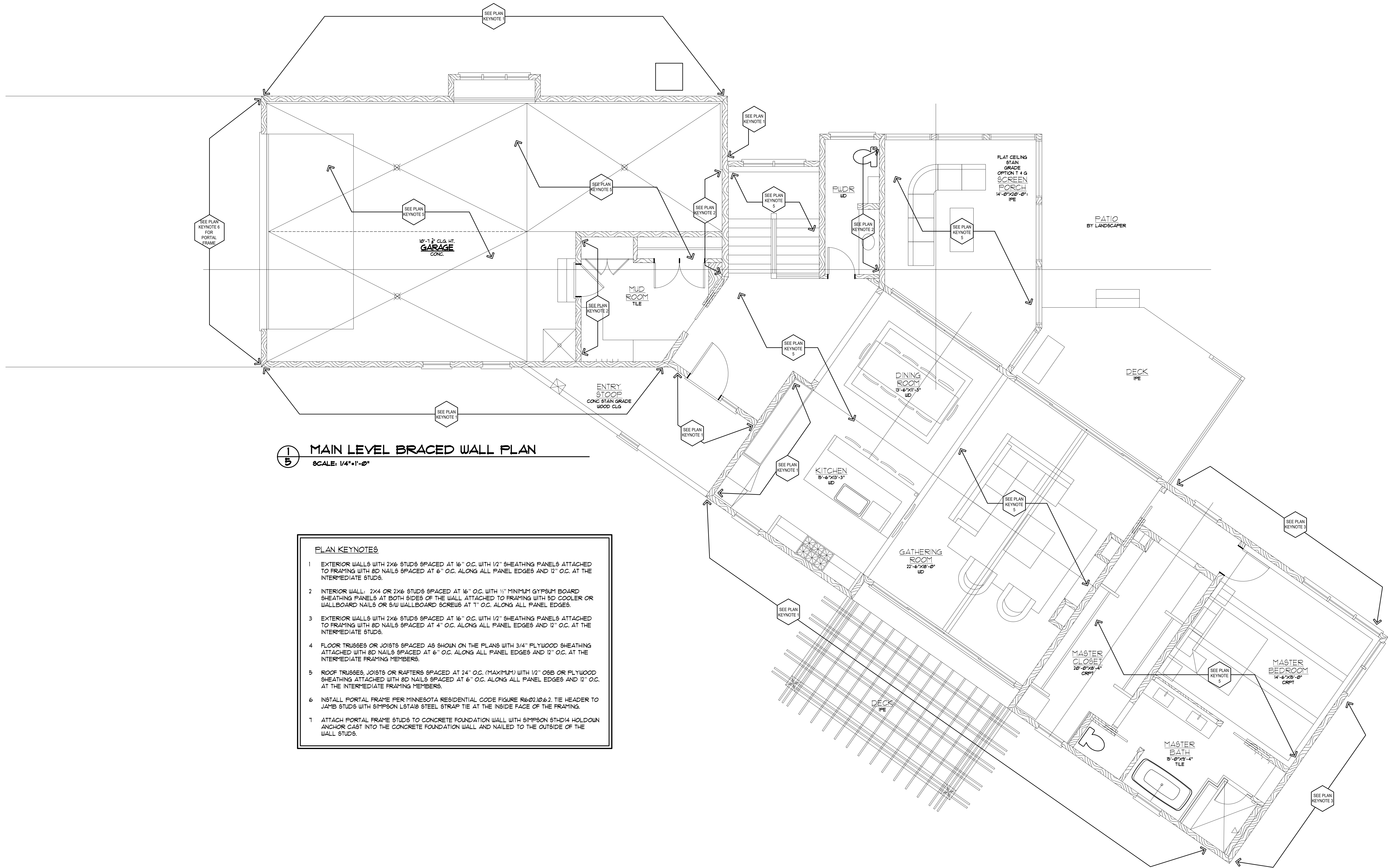

**1**  
**5** **MAIN LEVEL BRACED WALL PLAN**  
SCALE: 1/4"=1'-0"

- PLAN KEYNOTES**
- 1 EXTERIOR WALLS WITH 2X6 STUDS SPACED AT 16" O.C. WITH 1/2" SHEATHING PANELS ATTACHED TO FRAMING WITH 8D NAILS SPACED AT 6" O.C. ALONG ALL PANEL EDGES AND 12" O.C. AT THE INTERMEDIATE STUDS.
  - 2 INTERIOR WALL: 2X4 OR 2X6 STUDS SPACED AT 16" O.C. WITH 1/2" MINIMUM GYPSUM BOARD SHEATHING PANELS AT BOTH SIDES OF THE WALL ATTACHED TO FRAMING WITH 5D COOLER OR WALLBOARD NAILS OR 5/16 WALLBOARD SCREWS AT 1" O.C. ALONG ALL PANEL EDGES.
  - 3 EXTERIOR WALLS WITH 2X6 STUDS SPACED AT 16" O.C. WITH 1/2" SHEATHING PANELS ATTACHED TO FRAMING WITH 8D NAILS SPACED AT 4" O.C. ALONG ALL PANEL EDGES AND 12" O.C. AT THE INTERMEDIATE STUDS.
  - 4 FLOOR TRUSSES OR JOISTS SPACED AS SHOWN ON THE PLANS WITH 3/4" PLYWOOD SHEATHING ATTACHED WITH 8D NAILS SPACED AT 6" O.C. ALONG ALL PANEL EDGES AND 12" O.C. AT THE INTERMEDIATE FRAMING MEMBERS.
  - 5 ROOF TRUSSES, JOISTS OR RAFTERS SPACED AT 24" O.C. (MAXIMUM) WITH 1/2" OSB OR PLYWOOD SHEATHING ATTACHED WITH 8D NAILS SPACED AT 6" O.C. ALONG ALL PANEL EDGES AND 12" O.C. AT THE INTERMEDIATE FRAMING MEMBERS.
  - 6 INSTALL PORTAL FRAME PER MINNESOTA RESIDENTIAL CODE FIGURE R602.10.2. TIE HEADER TO JAMB STUDS WITH SIMPSON L9T18 STEEL STRAP TIE AT THE INSIDE FACE OF THE FRAMING.
  - 7 ATTACH PORTAL FRAME STUDS TO CONCRETE FOUNDATION WALL WITH SIMPSON 5THD4 HOLDOWN ANCHOR CAST INTO THE CONCRETE FOUNDATION WALL AND NAILED TO THE OUTSIDE OF THE WALL STUDS.