

# EXTERIOR WALL DETAIL

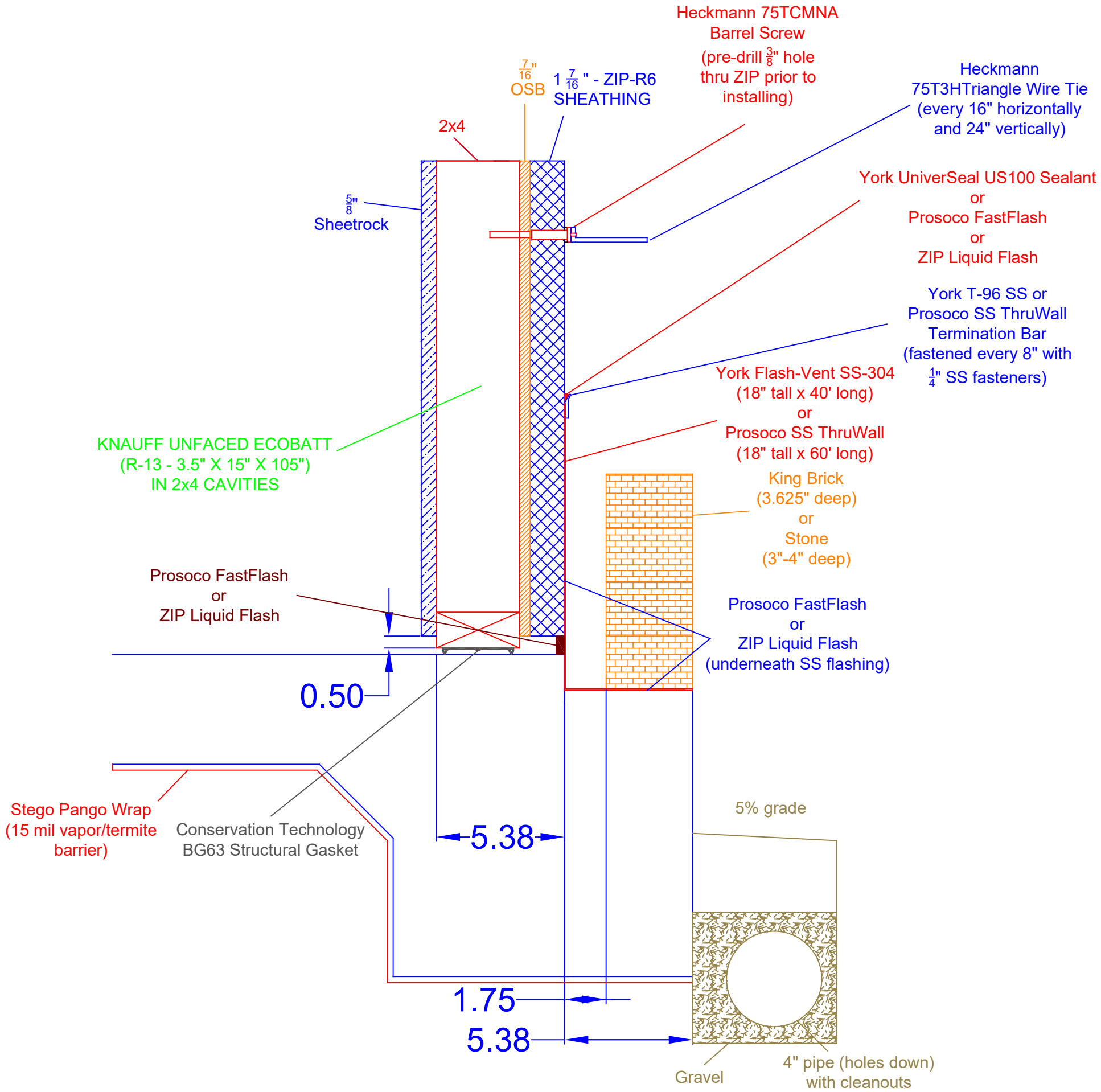

## FLASHING DETAIL

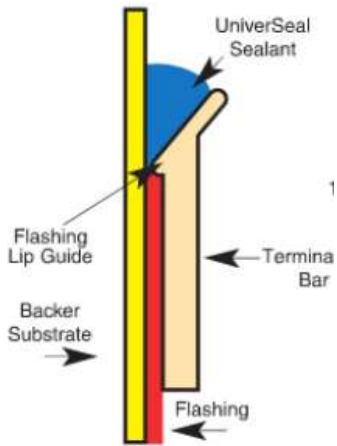

### Not Shown:

1. York SS-304/Prosoco SS ThruWall inside corner and outside corner dams
2. York 304 splice tape (4" wide)
3. Stainless Steel weep vents (every 2-3 bricks, not to exceed 24") on bottom of wall and top of wall

### Other Notes:

1. Use Heckmann Building Products Barrell Screw P/N 75TCMNA (1.5" long) and Triangle Wire Tie (Pos-I-Tie System) P/N 75T3H ( $\frac{3}{16}$ " x 3" long, hot-dipped galvanized) to secure brick/stone to wall panel