

## Wall Section Notes: (Outside to Inside)

LP Smartside Lap Siding  
1x4 Rainscreen  
Supplemental WRB for Polyiso  
(1) Layer 2.5" Polyiso, Fiberglass Facing  
(1) Layer 1.75" Polyiso, Fiberglass Facing  
Zip 7/16" Sheathing - Seams taped, liquid flashed at sill and all fastener penetrations.  
Existing 2x4 Framing  
Densepack Cellulose  
Interior Air Barrier - Intello on Wall and Ceiling

Note: A 1 1/2" service cavity will be used on Master Bed, Master Bath, Kitchen, and Bath 1. All other areas will have existing plaster finishes.

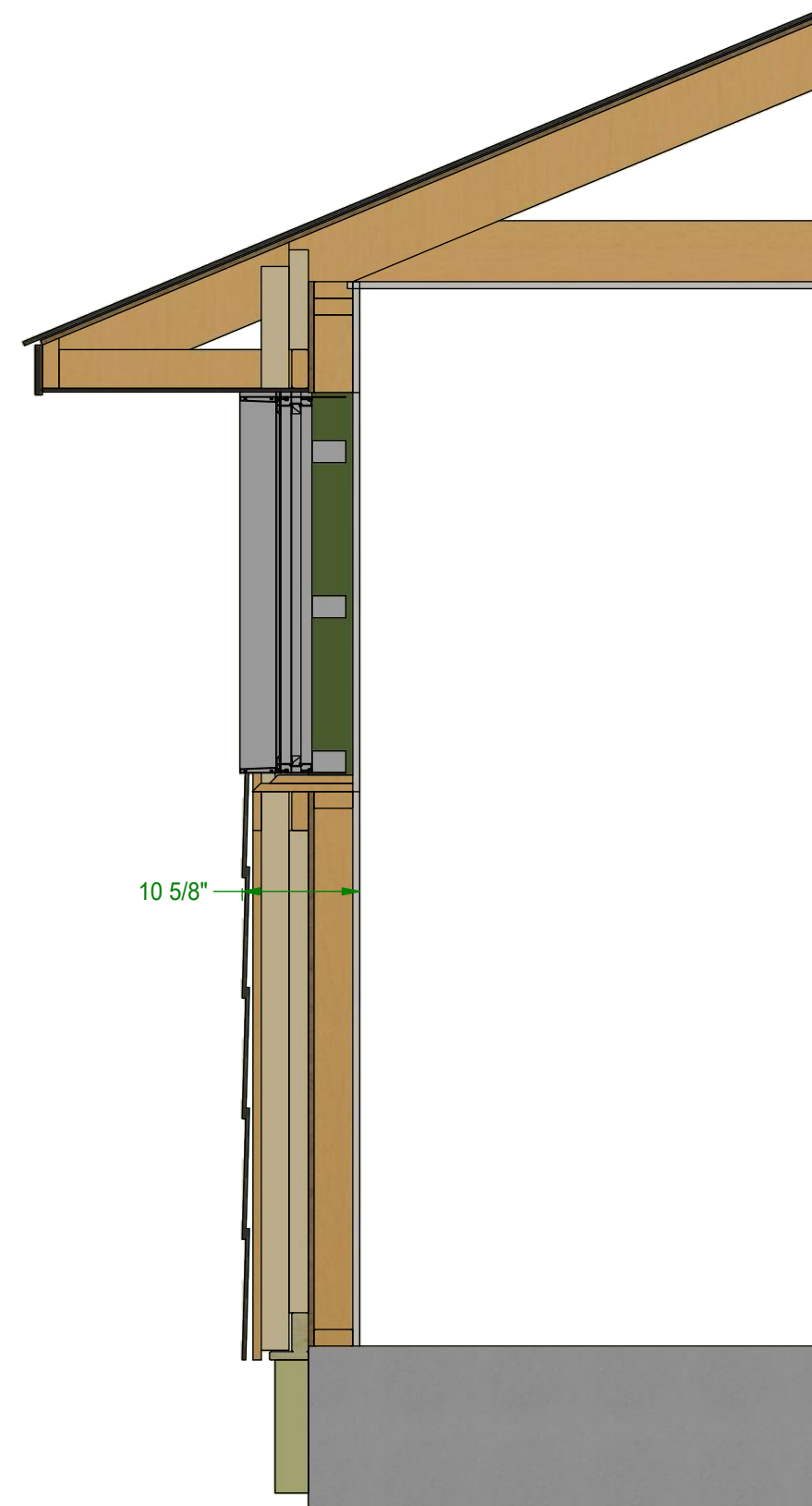

PLAN VIEW75