

OUTDOOR DESIGN CONDITIONS

Weather station: Tucson IAP

Summer Outdoor F:	110	Summer Indoor F:	75	Design Grains:	-26	Daily Range:	Medium
Winter Outdoor F:	34	Winter Indoor F:	70	Cooling RH:	45	Elevation (Ft):	2,556

LOAD CALCULATION TOTALS

HVAC System: Mitsubishi Mini Split

Heated square footage:	681	Heating BTUH:	10,187
Cooled square footage:	681	Cooling BTUH:	13,027
Heated volume (above grade CF):	5,448	CFM:	599
Cooled volume (above grade CF):	5,448	Sensible cooling:	11,873
Exposed wall area (SF):	792	Latent cooling:	1,155
		SHR:	0.911

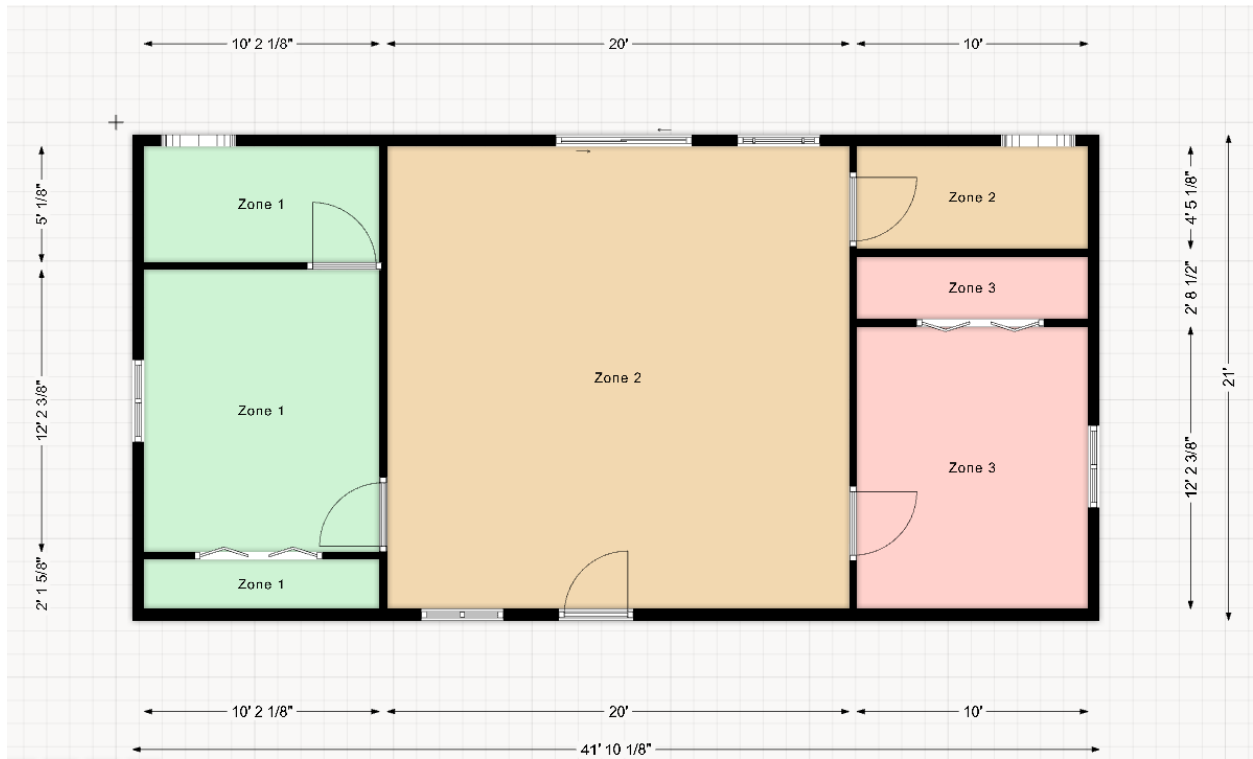

HEATING AND COOLING LOADS

Heating Loads		
Section	Area	Heat Loss
aboveGradeWalls	618	2,025
ceilings	307	321
doors	96	1,624
floors	681	3,339
infiltration	0	1,896
skylights	0	0
windows	78	983
Totals		10,187

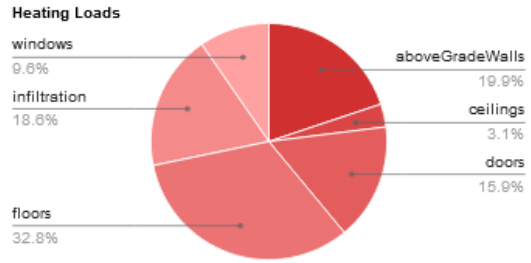

Cooling Loads			
Section	Area	Sensible	Latent
AEDExcursion	0	0	0
aboveGradeWalls	618	1,771	0
appliances	0	4,478	129
ceilings	307	418	0
doors	96	1,624	0
floors	681	0	0
infiltration	0	967	-324
occupants	0	1,380	1,200
plants	0	0	150
skylights	0	0	0
windows	78	1,233	0
Totals		11,873	1,155

