



-  = NO WORK IN SHADED AREAS
-  = NEW FRAMING (ORANGE)
-  = EXISTING WALLS NO WORK (BLUE)



- 13 1/2' CEILING PEAK
- FURR OUT SLOPED CEILING STUDS 1 1/2"
- SMOOTH CEILINGS
- X-CRACK & STRAIGHT FLEX VAULTED JOINTS

FIREPLACE

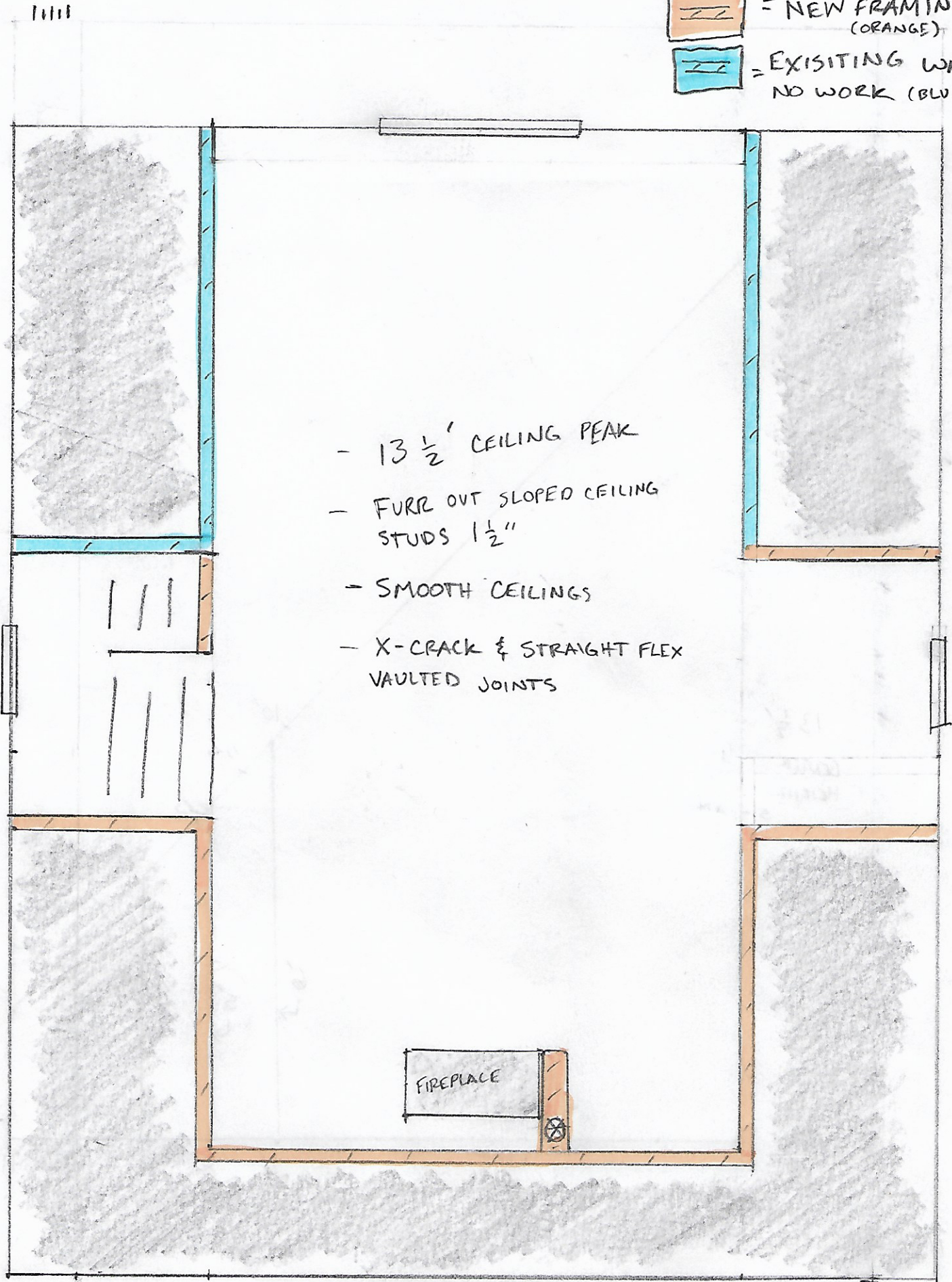

1/4" = 1'