

LSTA24 (Simpson Strong-Tie or USP Structural Connectors) strap with twelve 10d (0.148 x 1½") nails required at H5S with slopes greater than 3:12

Additional blocking may be required for shear transfer.

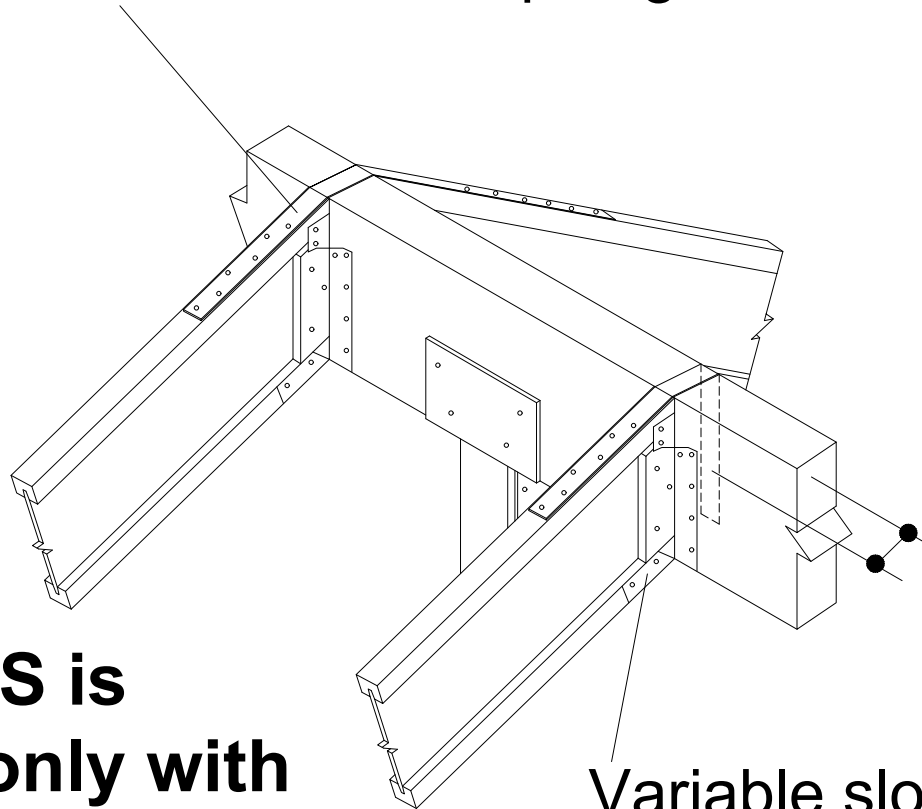

Strap nails:
Leave 2³/₈" minimum end distance

Detail H5S is allowed only with joist depths ≤ 16".

Variable slope joist hanger. Beveled web stiffener required each side.

