

## Removing the Top Panel & Console

**⚠ WARNING**



**Electrical Shock Hazard**  
Disconnect power before servicing.  
Replace all parts and panels before operating.  
Failure to do so can result in death or electrical shock.

### To Remove the Console

1. After removing the top panel, remove connector P2 from the CCU and disconnect the in-line connector between the UI and drum light (see Figure 2).

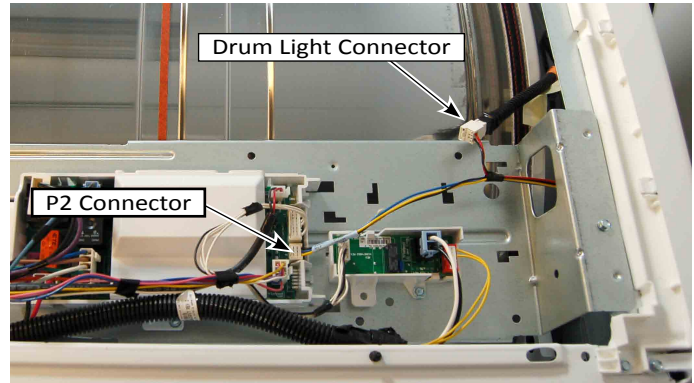

Figure 2

### To Remove the Top Panel

1. Unplug dryer or disconnect power.
2. Remove the two (2) 1/4" hex-head screws from the top panel as illustrated in Figure 1.



Figure 1

2. Remove the two (2) 1/4" hex head screws securing the console to the cabinet (see Figure 3).



Figure 3

3. Lift up on console and pull out to remove from dryer.

3. Lift the rear of the top panel, pull back, and remove top panel from the dryer.



## Removing the Front Panel & Door Switch

### ⚠ WARNING



**Electrical Shock Hazard**  
 Disconnect power before servicing.  
 Replace all parts and panels before operating.  
 Failure to do so can result in death or electrical shock.

### To Remove the Front Panel & Door Switch

1. Unplug dryer or disconnect power.
2. Perform the procedures on page 4-4, "Removing the Top Panel" and "Removing the Console" prior to performing the following steps.
3. Disconnect Door Switch connector (see Figure 1).

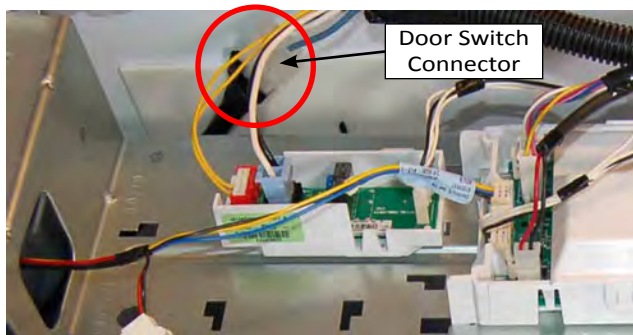

Figure 1

4. Open dryer door and pull the primary lint screen straight up and out. Next, remove the two Phillips screws. Close the door.
5. Open the secondary filter door at the bottom of the dryer. Grab the handle to pull out the secondary lint filter box (see Figure 2). Remove secondary filter door from front panel.

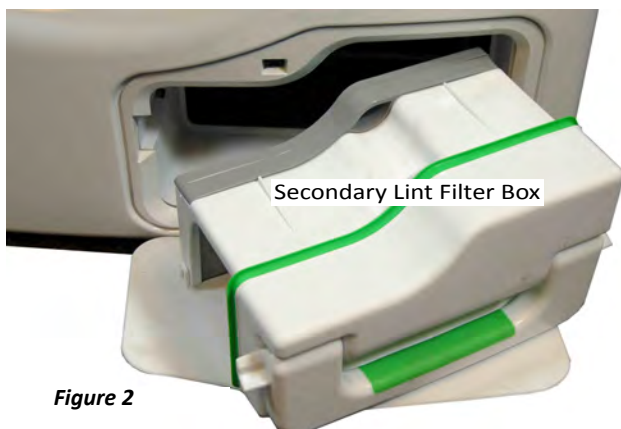

Figure 2

6. Remove four (4) 1/4" hex-head screws from the bottom of the front panel (see Figure 3).
7. Remove three (3) 1/4" hex-head screws from the top of the front panel (see Figure 3).



Figure 3

8. Lift the front panel assembly up off the tabs and away from the dryer.
9. Detach harness clip(s) from front panel. Depress the tabs on each side of the door switch and feed the switch assembly through the opening (see Figure 4).

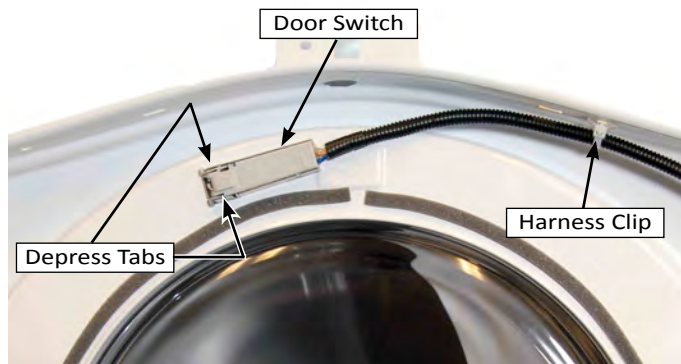

Figure 4



## Removing the Belt, Drum, and Rollers

### ⚠ WARNING



**Electrical Shock Hazard**  
 Disconnect power before servicing.  
 Replace all parts and panels before operating.  
 Failure to do so can result in death or electrical shock.

### To Remove the Belt and Drum

1. Unplug dryer or disconnect power.
2. Remove drain hose from standpipe or laundry tub.
3. Perform the procedures on page 4-4, "Removing the Top Panel" and "Removing the Console" prior to performing the following steps.
4. Perform the procedures on page 4-7, "Removing the Front Panel" prior to performing the following steps.
5. Remove front 1/4" hex-head screw securing the control bracket to the console bracket...or remove the entire control bracket (see Figure 1).

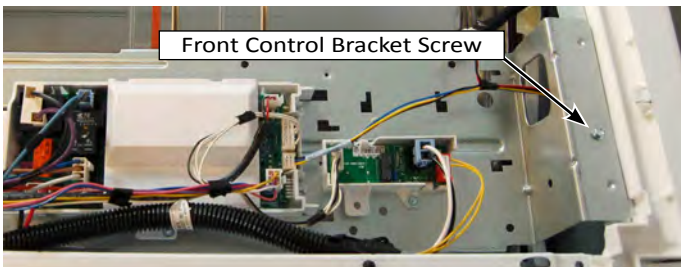

Figure 1

6. Remove the four (4) 1/4" hex-head screws from the console bracket and remove (see Figure 2).

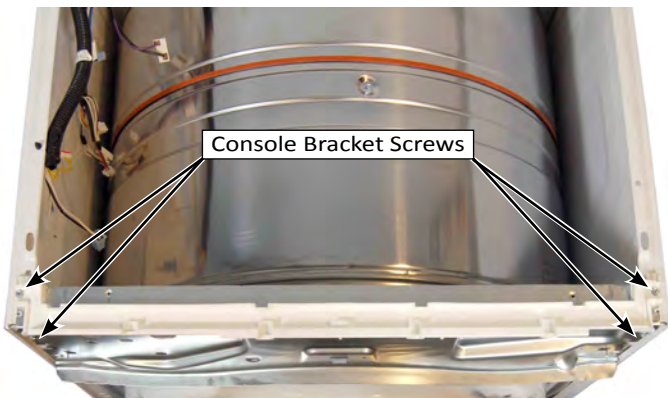

Figure 2

7. Disconnect Moisture Sensor connector (see Figure 3).

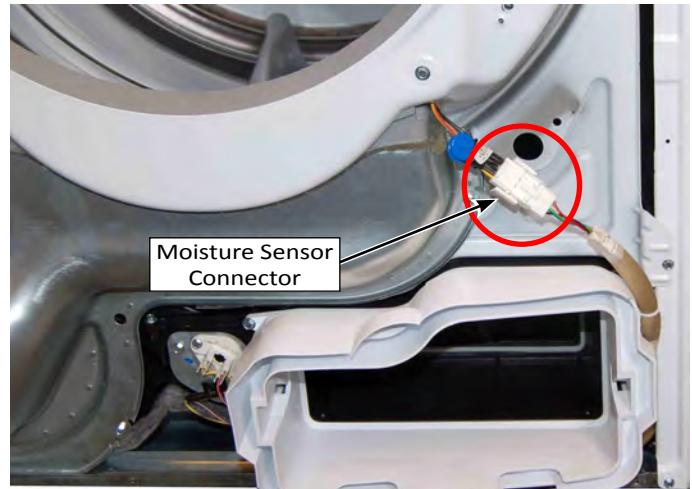

Figure 3

8. Remove two (2) 1/4" hex-head screws securing the Outlet Grill & Housing Assembly to the front bulkhead (see Figure 4).

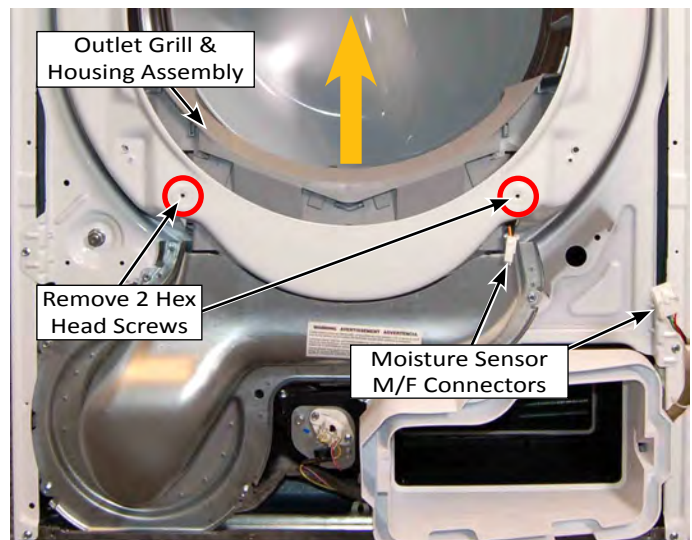

Figure 4

9. Remove the four (4) 1/4" hex-head screws from the secondary lint assembly bezel and remove (see Figure 5).



Figure 5

## Removing the Belt, Drum, and Rollers (continued)

10. Remove the five (5) 1/4" hex-head screws from the lint duct as illustrated in Figure 6. Swivel the lint duct down from the bulkhead and remove.

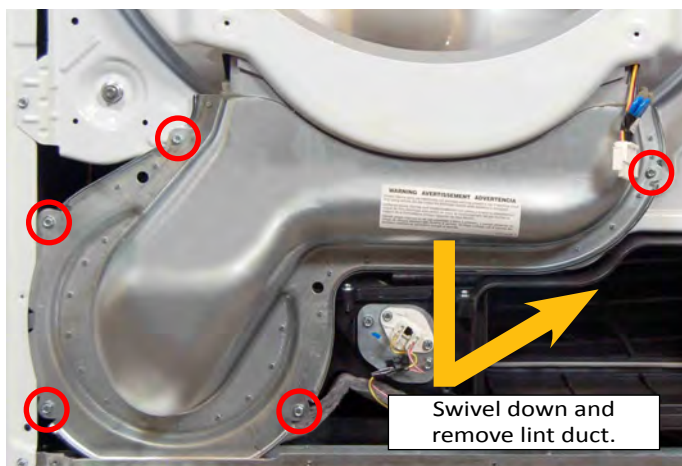

Figure 6

11. Remove the four (4) 1/4" hex-head screws securing the front bulkhead to the side panels as illustrated in Figure 7. Lift the bulkhead up off the side-panel tabs and remove.

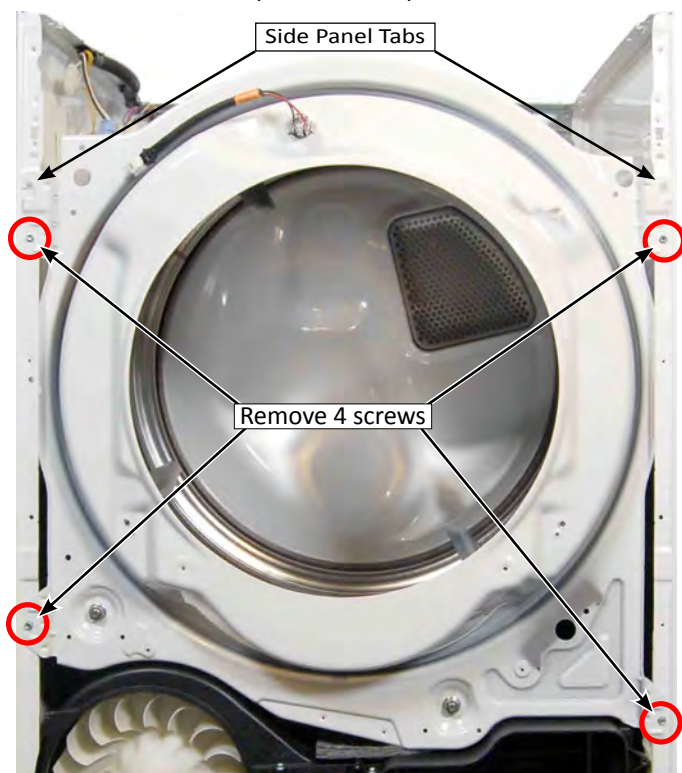

Figure 7

12. Reach under the drum, (raise it as far as it will go), and push the idler pulley arm, on the back of the drive motor, to the left to relieve the tension on the belt, then remove the belt from the pulley. See Figure 8.

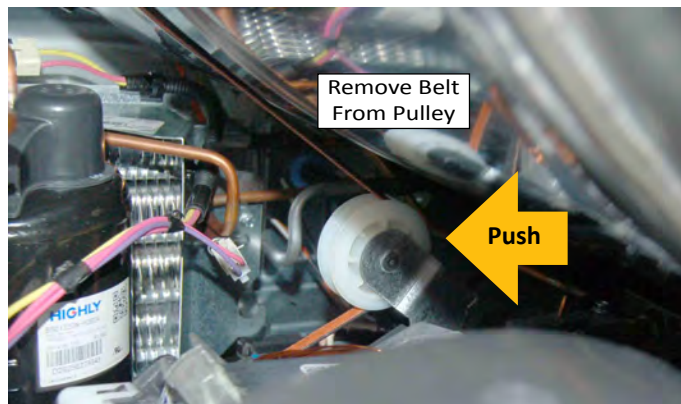

Figure 8

13. Slide the belt off the front of the drum and remove belt.  
14. Lift the drum and remove it from the dryer cabinet.

### To Remove a Roller

1. Pry the sides of the triangular ring out of the groove in the roller shaft with a small screwdriver (see Figure 9).



Figure 9

2. Slide the roller off the roller shaft (see Figure 10).



Figure 10

3. To remove the roller shaft, remove the 9/16" nut and washer from the roller support, and remove the support and remaining triangular ring. See Figure 11.



Figure 11



## Removing the Drive Motor

### ⚠ WARNING



**Electrical Shock Hazard**  
 Disconnect power before servicing.  
 Replace all parts and panels before operating.  
 Failure to do so can result in death or electrical shock.

### To Remove the Drive Motor

1. Unplug dryer or disconnect power.
2. Remove drain hose from standpipe or laundry tub.
3. Perform the procedures on page 4-4, "Removing the Top Panel" and "Removing the Console" prior to performing the following steps.
4. Perform the procedures on page 4-7, "Removing the Front Panel" prior to performing the following steps.
5. Perform the procedures on page 4-10, "Removing the Belt and Drum" prior to performing the following steps.
6. Reach around to the back of the blower housing and attached a 7/16" open-end wrench to the hex-end of the motor shaft, and a ratchet with a 5/8" socket over the hex-head nut on the blower wheel (see Figure 1).
7. Turn the blower wheel clockwise (shown by the "REMOVE" arrow that is embossed on the front of the wheel) and remove the wheel from the motor shaft (see Figure 1).

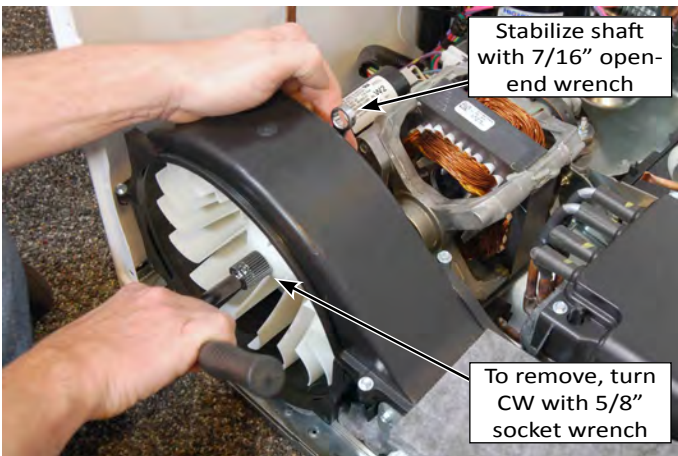

Figure 1

8. Lift the locking tabs on the top and bottom of the motor harness plug and disconnect the plug from the motor terminals.

9. Locate the front and rear motor clips as illustrated in Figure 2 below. Using a small flat blade screwdriver, insert the blade of the screwdriver into the pocket at the tip of the clip. Pry the clips off the tab and remove.

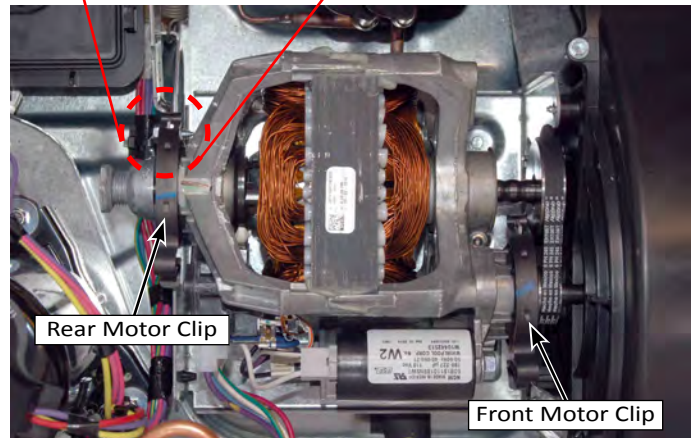
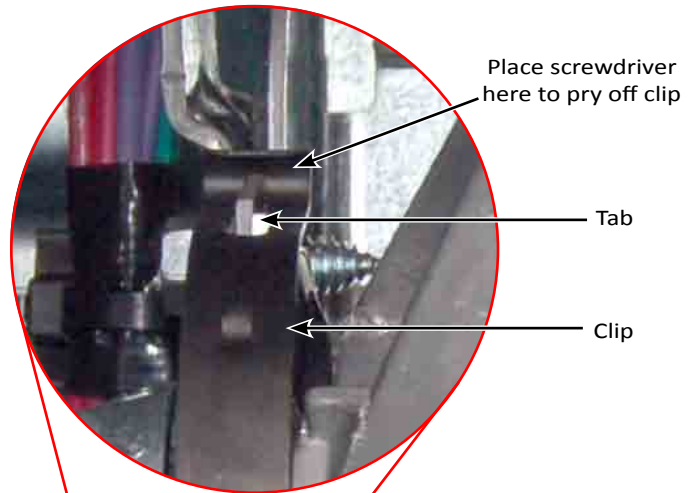

Figure 2

10. Lift motor from support brackets, slide shaft from blower wheel housing and remove motor from cabinet.

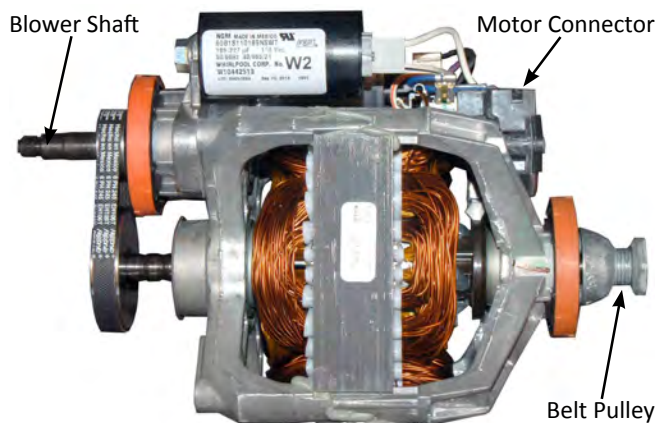

Figure 3



## Removing the Drain Pump & Float Assembly

### **⚠ WARNING**



**Electrical Shock Hazard**  
 Disconnect power before servicing.  
 Replace all parts and panels before operating.  
 Failure to do so can result in death or electrical shock.

### To Remove the Drain Pump and Float Assembly

**IMPORTANT:** The Drain Pump and Float Switch are replaced together as part of the Sump Cover assembly.

1. Unplug dryer or disconnect power.
2. Remove drain hose from standpipe or laundry tub.
3. Perform the procedures on page 4-4, "Removing the Top Panel" and "Removing the Console" prior to performing the following steps.
4. Perform the procedures on page 4-7, "Removing the Front Panel" prior to performing the following steps.
5. Perform the procedures on page 4-10, "Removing the Belt and Drum" prior to performing the following steps.
6. Disconnect the Drain Pump harness (see Figure 1 below).
7. Disconnect the Float Switch harness (see Figure 1 below).
8. Remove the drain hose from the sump cover.
9. Remove the two (2) 1/4" hex-head screws securing the cover to the sump assembly (as illustrated in Figure 1). Remove the cover assembly, containing the pump and float from the base of the dryer.

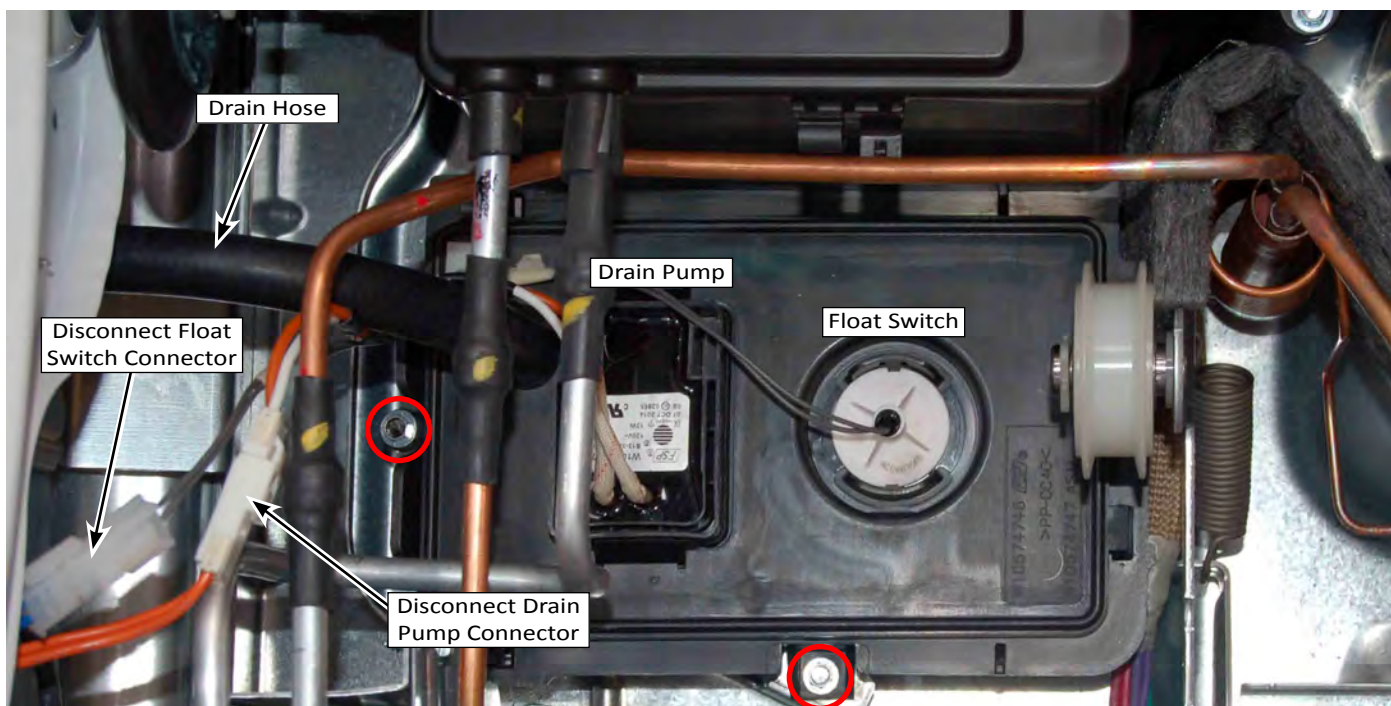

Figure 1



## Removing the Reed Lint Switch

### ⚠ WARNING



**Electrical Shock Hazard**  
**Disconnect power before servicing.**  
**Replace all parts and panels before operating.**  
**Failure to do so can result in death or electrical shock.**

### To Remove the Reed Lint Switch

**NOTE:** The Reed Lint Switch is “heat staked” to the heat exchanger cover. To replace the reed lint switch, the entire cover must be replaced.

1. Unplug dryer or disconnect power.
2. Remove drain hose from standpipe or laundry tub.
3. Perform the procedures on page 4-4, “Removing the Top Panel” and “Removing the Console” prior to performing the following steps.
4. Perform the procedures on page 4-7, “Removing the Front Panel” prior to performing the following steps.
5. Perform the procedures on page 4-10, “Removing the Belt and Drum” prior to performing the following steps.
6. Perform Step 7 on page 4-12, to remove the blower prior to performing the following steps.
7. Disconnect the reed lint switch connector (see Figure 1 below).
8. Remove the one 1/4” hex-head screw located behind the blower wheel (see Figure 2 at right).
9. Remove the sixteen (16) 1/4” hex-head screws securing the cover to the heat exchanger assembly (as illustrated in Figure 3). Remove the cover assembly, containing the reed lint switch.

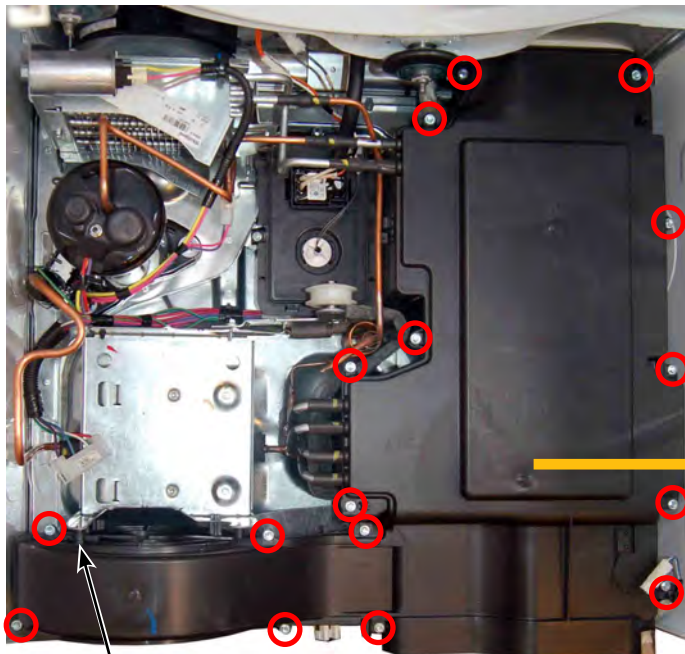

Figure 3 - Sealed System Base Assembly

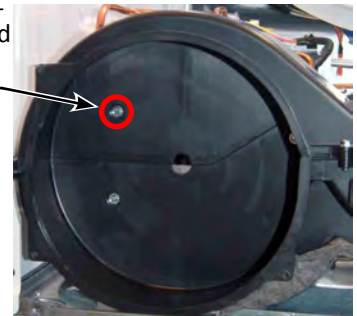

Figure 2

**IMPORTANT:** See cover reassembly notes on page 4-19.

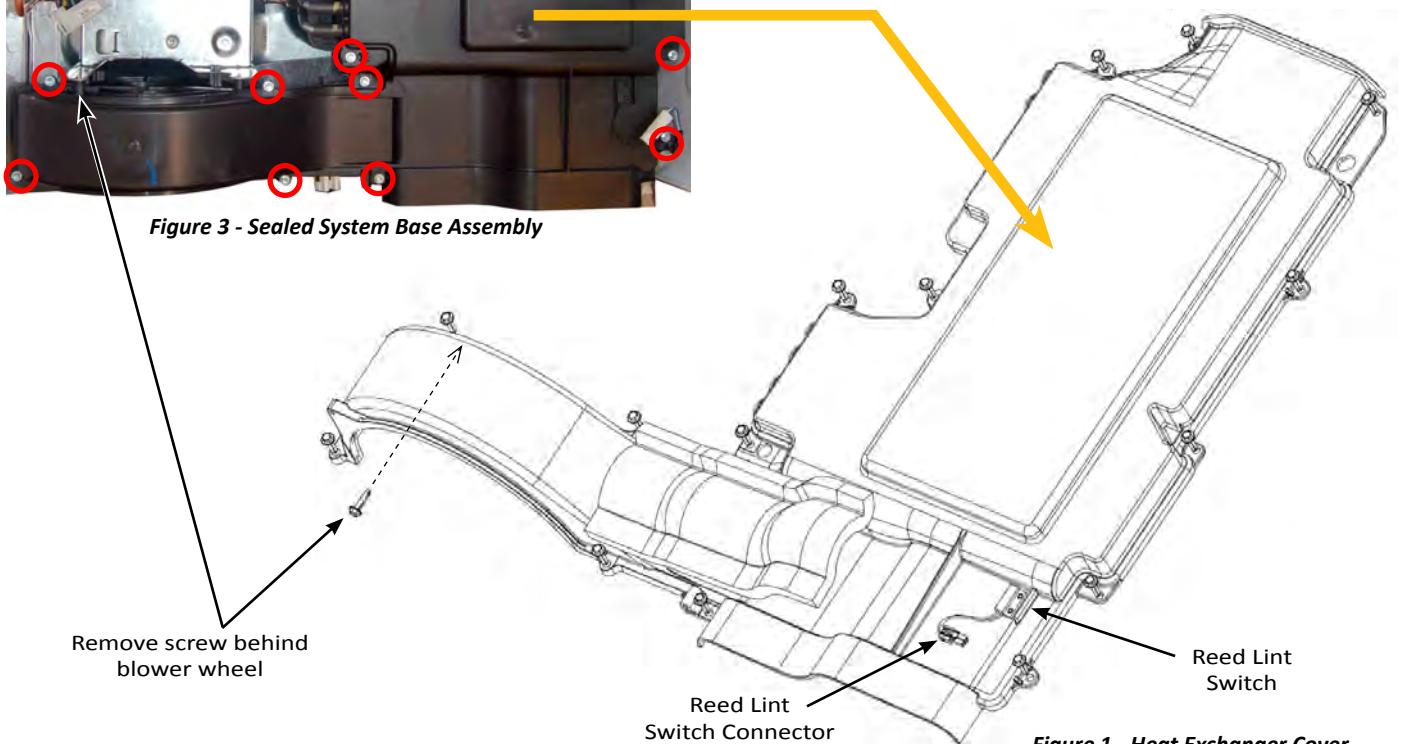

Figure 1 - Heat Exchanger Cover

Remove screw behind blower wheel

Reed Lint Switch Connector

Reed Lint Switch