

CONDITIONED SPACE ABOVE FLOOR

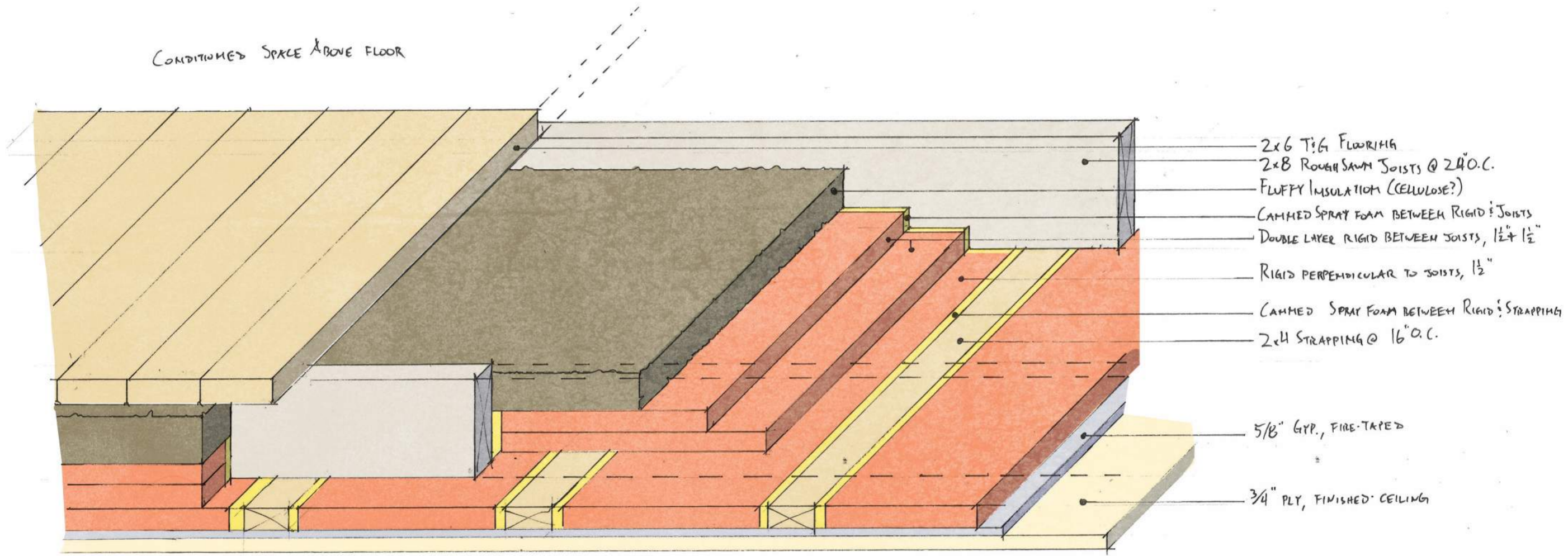

- 2x6 T&G FLOORING
- 2x8 ROUGH SAWN JOISTS @ 24" O.C.
- FLUFFY INSULATION (CELLULOSE?)
- CAMMED SPRAY FOAM BETWEEN RIGID JOISTS
- DOUBLE LAYER RIGID BETWEEN JOISTS, 1 1/2"
- RIGID PERPENDICULAR TO JOISTS, 1 1/2"
- CAMMED SPRAY FOAM BETWEEN RIGID STRAPPING
- 2x4 STRAPPING @ 16" O.C.
- 5/8" GYP., FIRE-TAPED
- 3/4" PLY, FINISHED CEILING

UNCONDITIONED / OCCASIONALLY HEATED GARAGE/SHOP SPACE BELOW CEILING