

HOUSE WITH BASEMENT FOUNDATION UP THIS BANK

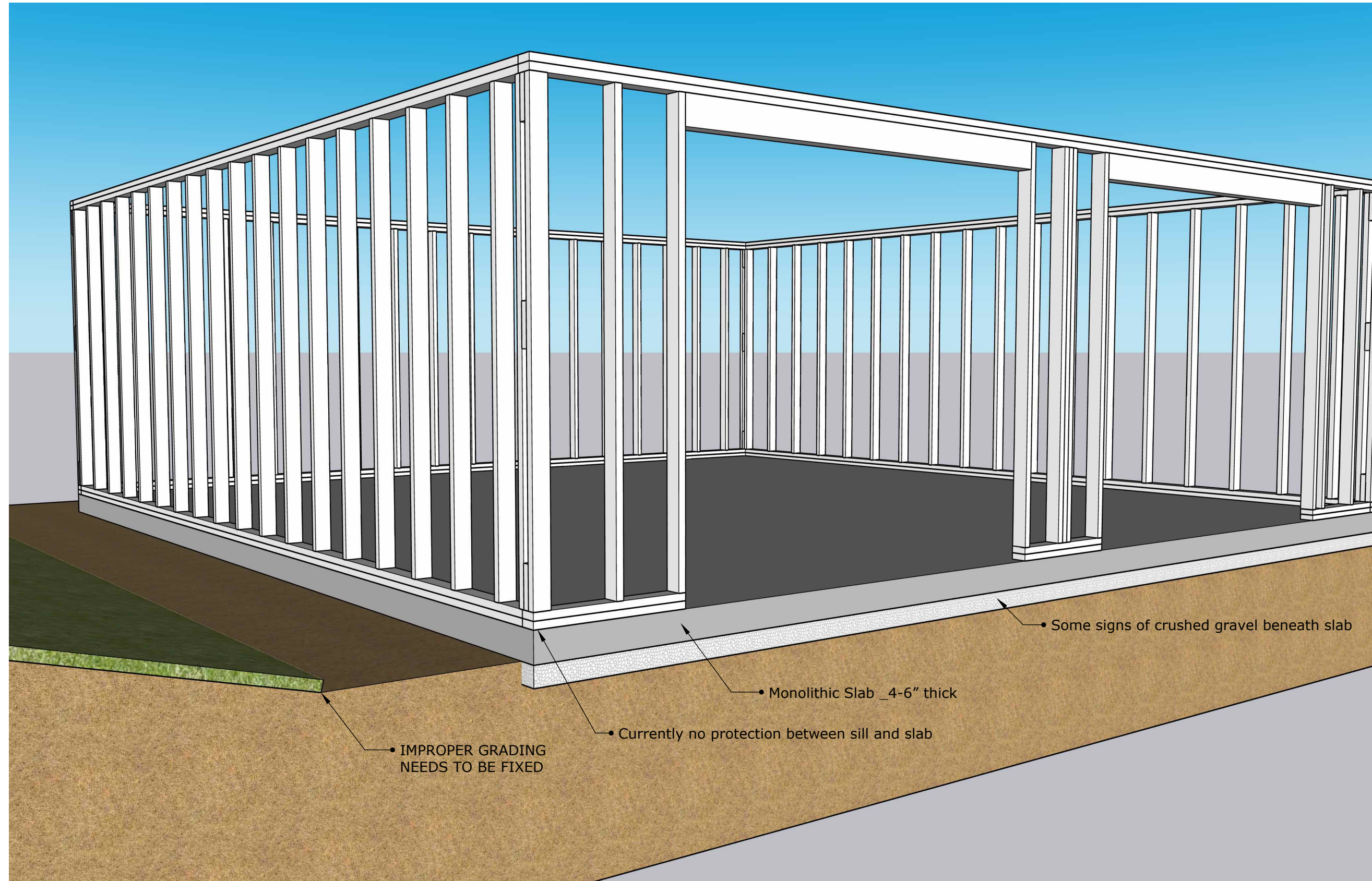

FRONT VIEW: 2 CAR GARAGE WITH UNINSULATED FLOATING SLAB

HOUSE WITH FOUNDATION UP THIS BANK



GRADE HAS BEEN BUILT UP
TO CREATE PAD FOR SLAB.
THERE ARE SIGNS OF EROSION.

BACK VIEW: 2 CAR GARAGE WITH UNINSULATED FLOATING SLAB

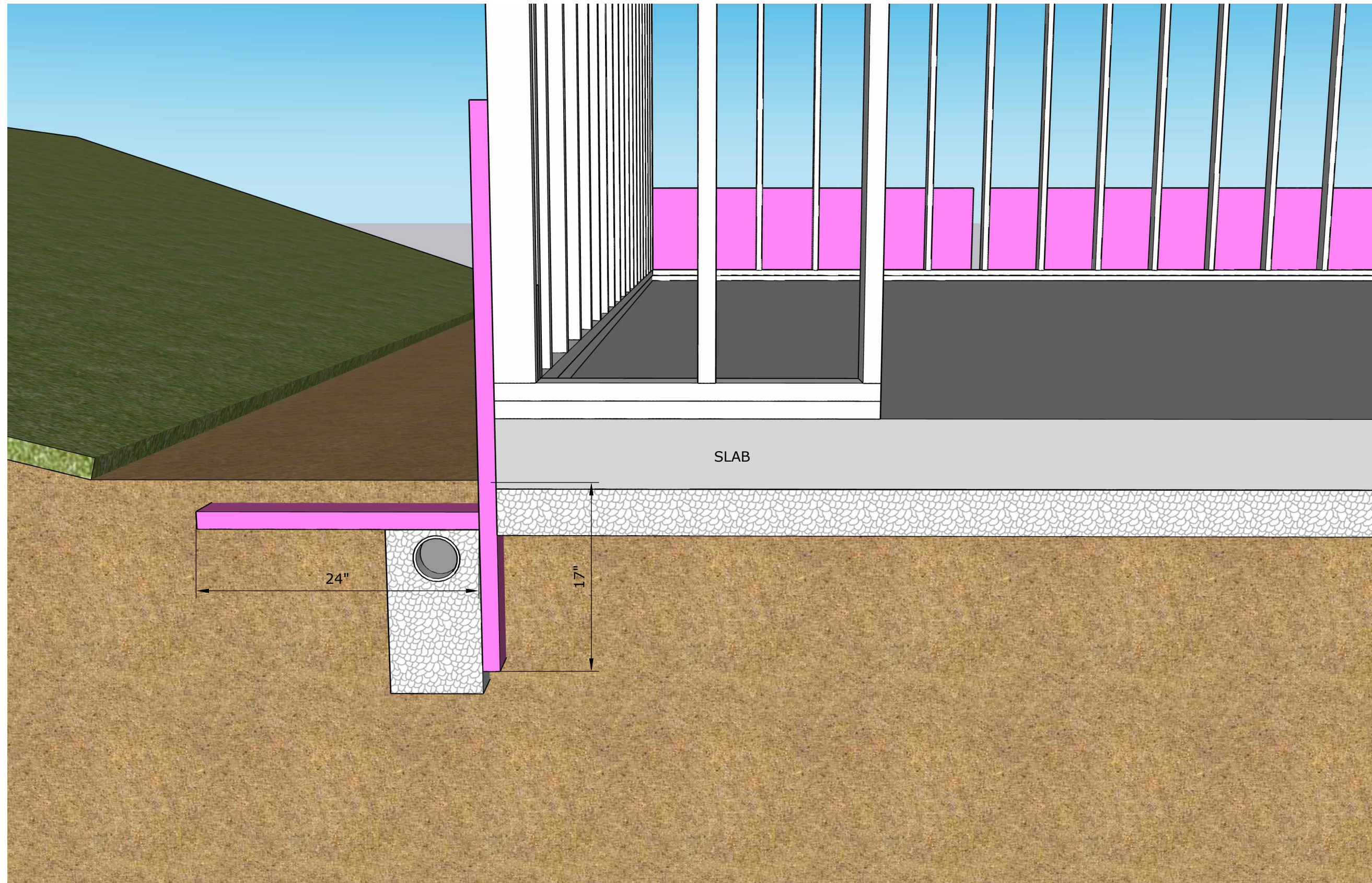

PROPOSAL ONE: FORST-PROTECTED SHALLOW FOUNDATION

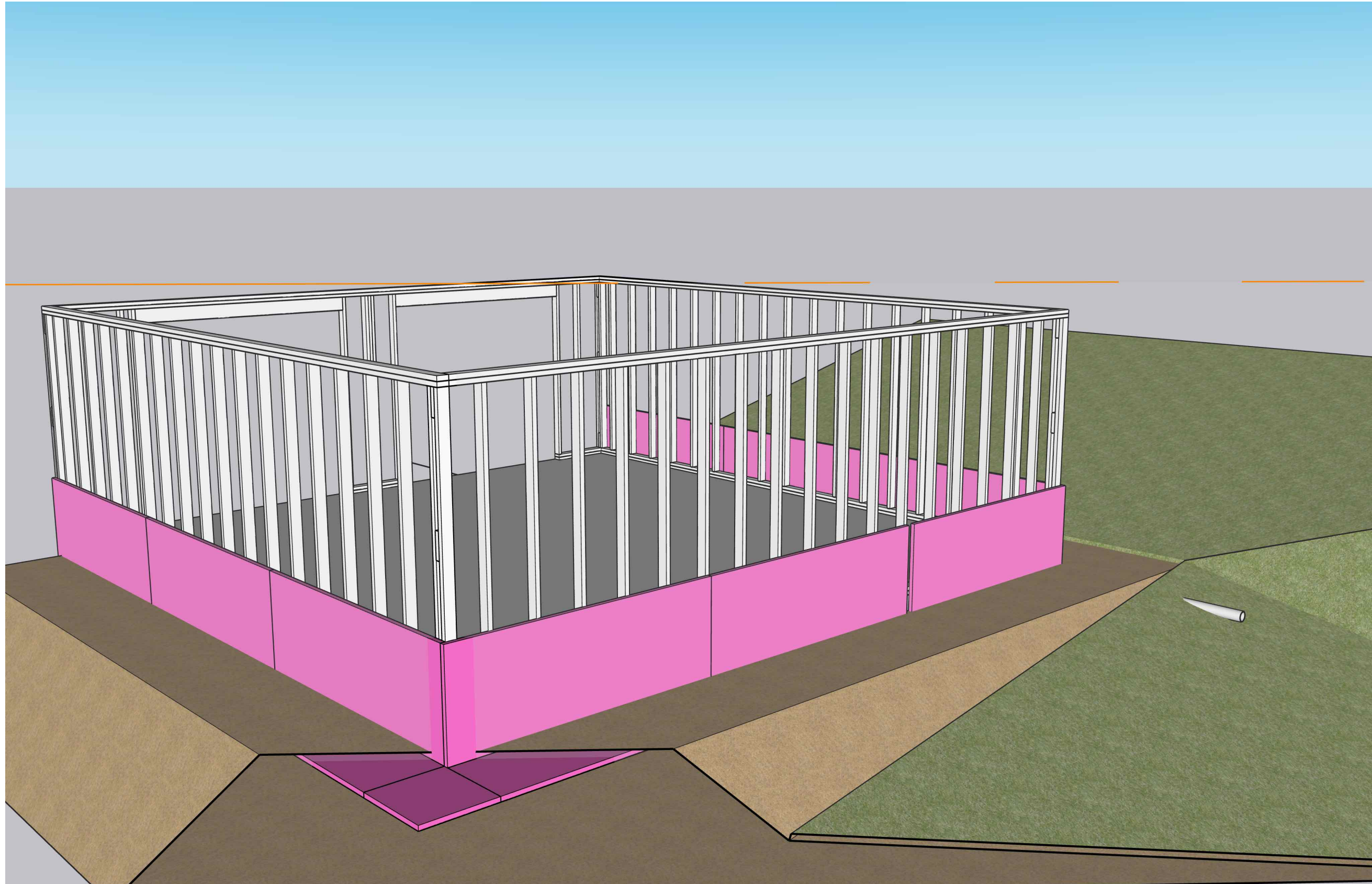

PROPOSAL ONE: FORST-PROTECTED SHALLOW FOUNDATION